

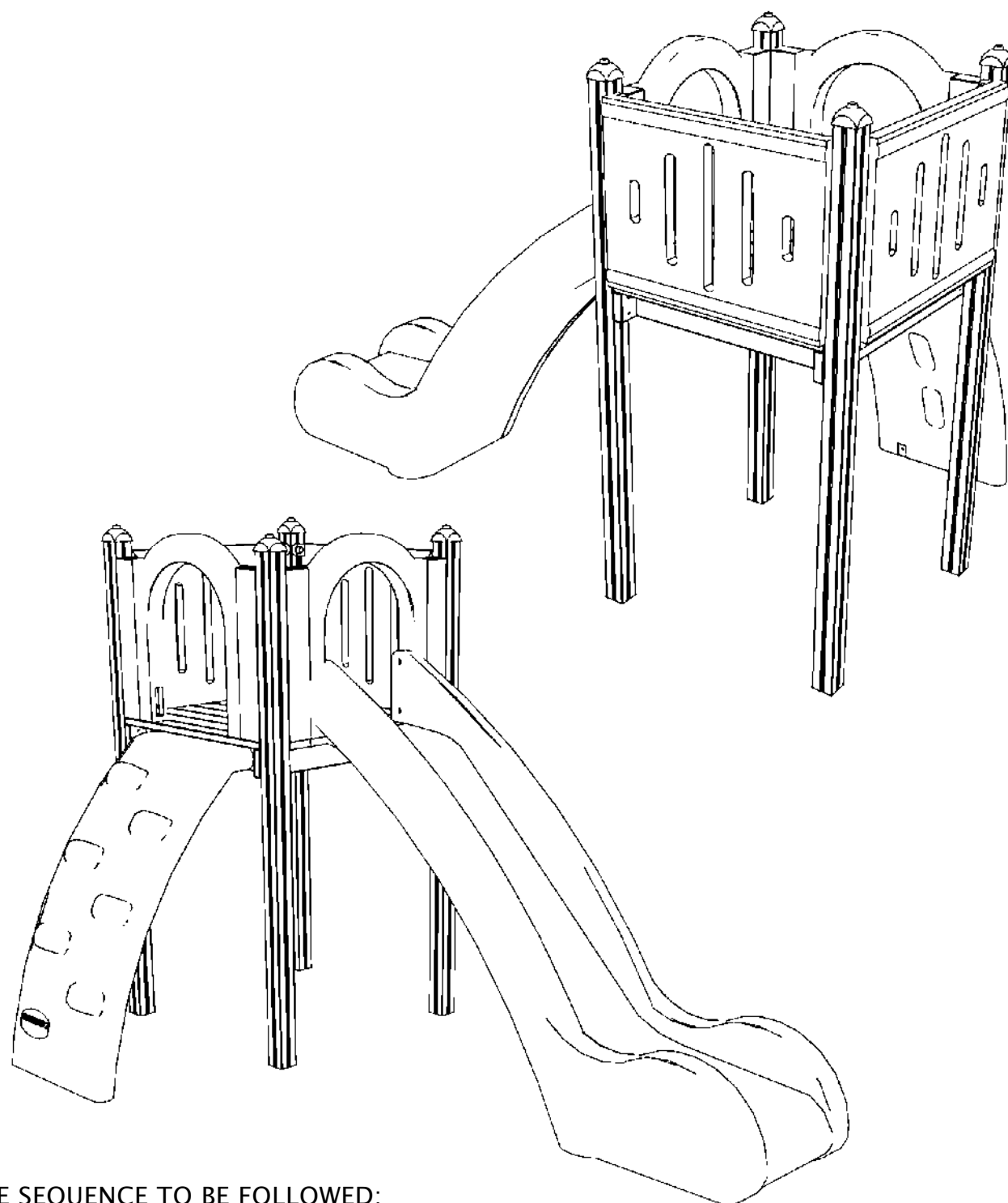

**MAX XM 144 R line
assembly
instructions**



TIME SEQUENCE TO BE FOLLOWED:

- | | |
|-------------------------|--|
| 1. STRUTS AND PLATFORMS | 5. CLIMBING BOARD |
| 2. ARCHWAY | 6. UNDERGROUND LAYING/ANCHORAGE OF STRUCTURE |
| 3. PARAPETS | |
| 4. SLIDE | |

Le misure sono espresse in cm.	SOLZOO		
Colori e modelli rappresentati sono puramente indicativi	denominazione e/o cliente :	istruzioni di montaggio Linea MAX XM 144 R	
firma esecutore : 	data : 28.06.2011	nr.	pag. 1/1

Article num.	fixing	CODE N.	NAME
1	2	xpe11	Shaped PE nut protection cap
2	2	xpe10	PE nut protection cap
3	4	xpe116	PE cap
4	4	-	ISO7089 Ø8 washer
5	2	-	UNI7473 M8 self-locking nut
7	2	-	UNI4017 M8X155 HEX SCREW

NOTA BENE: it is recommended to fix the bolts definitively and only insert the caps once the correct positioning of the elements has been verified.

NOTE:

- The colours and models in the image are purely indicative.
- The platform can be in engineered wood or wooden planking.

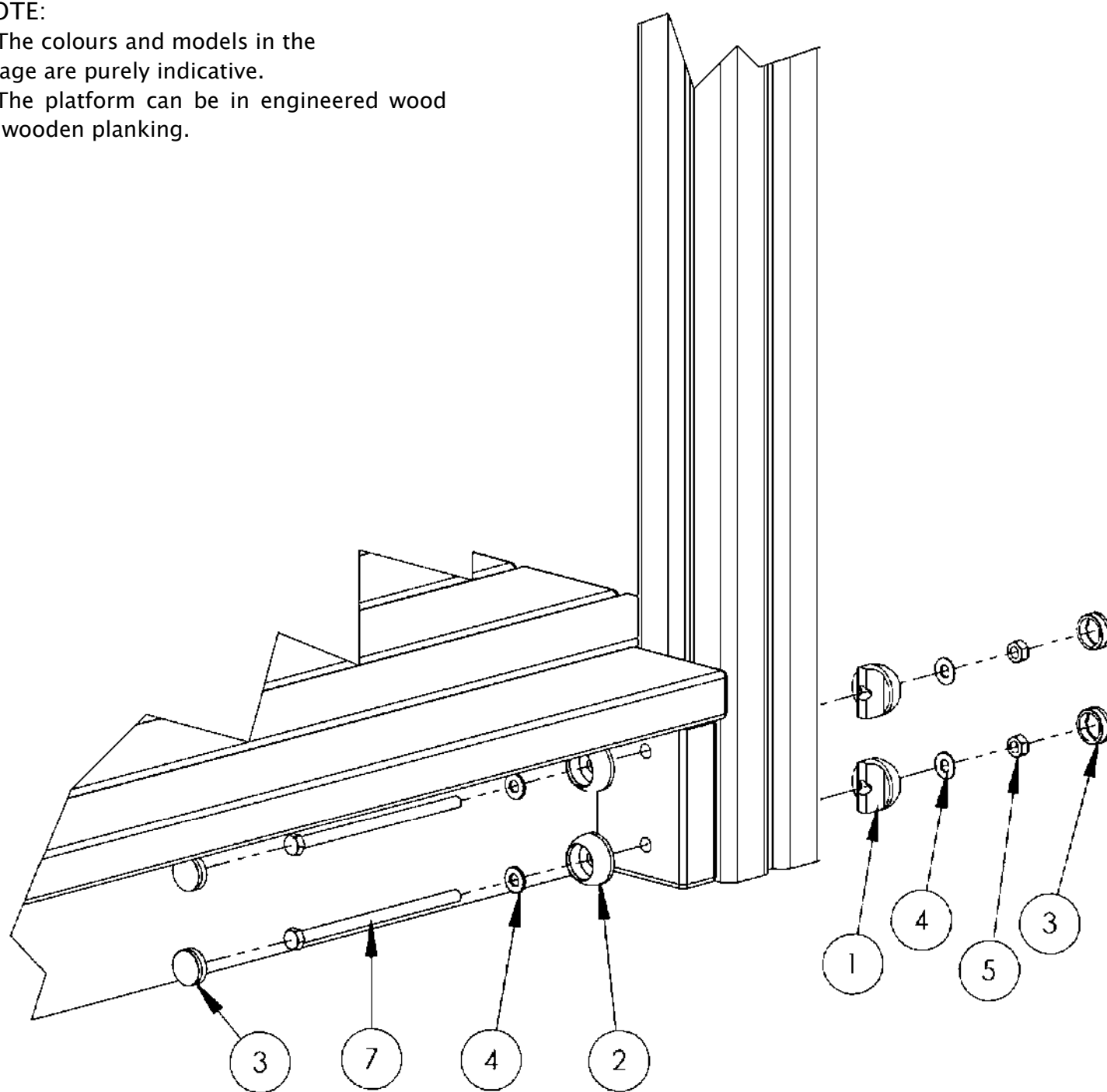



Le misure sono espresse in cm.	BOLZOE		
Colori e modelli rappresentati sono puramente indicativi	denominazione e/o cliente :	istruzioni di montaggio montanti e pianali	
firma esecutore :	data : 16.02.2011	nr.	pag.1/1

NOTA BENE: it is recommended to fix the bolts definitively and only insert the caps once the correct positioning of the elements has been verified.

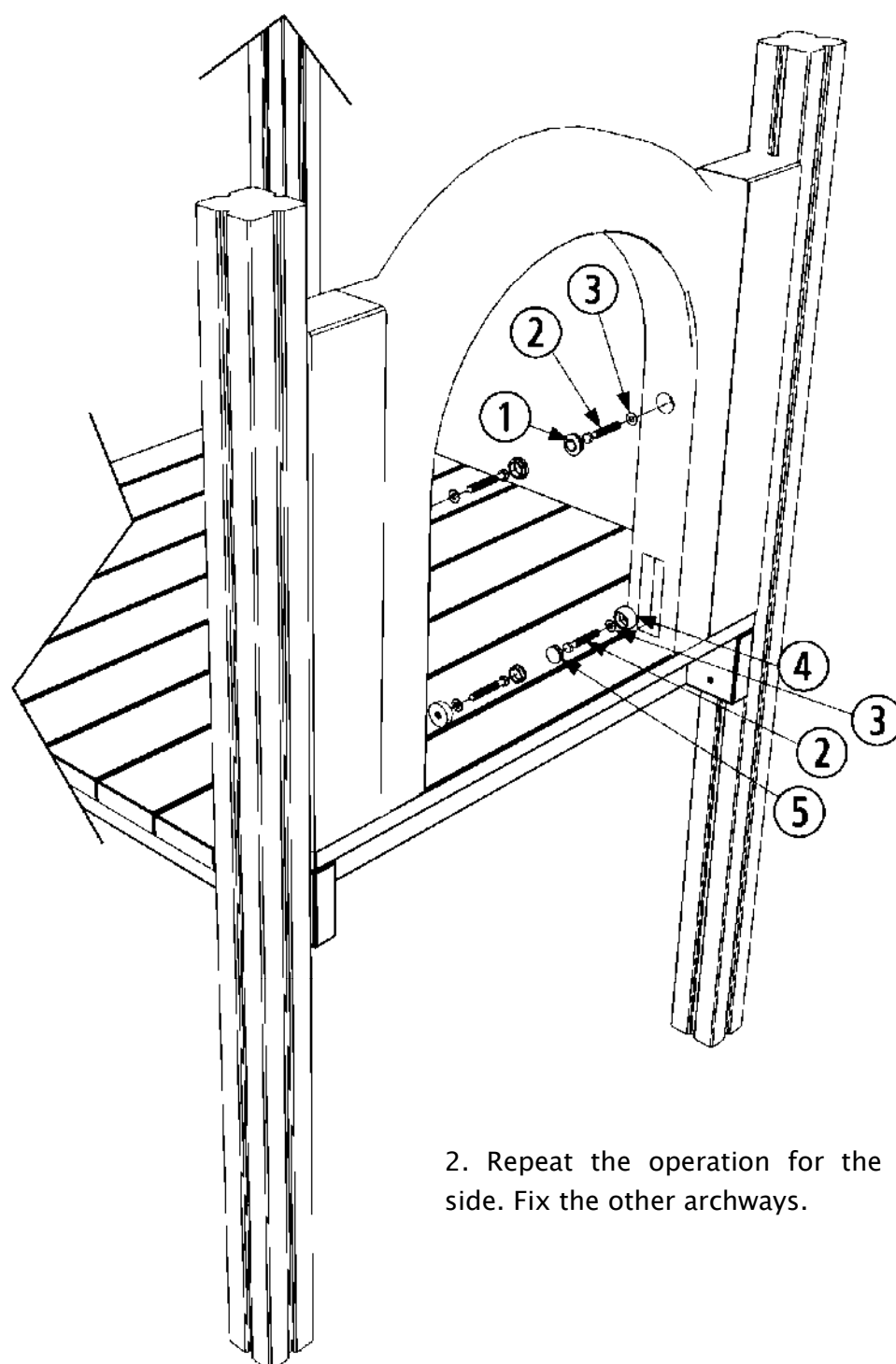
1. Position the archway between the struts and fix it by inserting: 1 x M8 washer (3), 1 x M8x260 TORX screw (2), 1 x Ø25 mm. winged PE cap (1) into the upper part;
1 x PE nut protection cap (4), 1 x M8 washer (3),
1 x M8x260 TORX screw (2), 1 x PE cap (5) into the lower part.



2. Repeat the operation for the opposite side. Fix the other archways.

Le misure sono espresse in cm.		
Colori e modelli rappresentati sono puramente indicativi	denominazione e/o cliente :	istruzioni montaggio entrata in Pe MAX-SULTAN-OXI-OASIS
firma esecutore : 	data : 03.03.2011	nr. pag. 1/1

NOTA BENE: it is recommended to fix the bolts definitively and only insert the caps once the correct positioning of the elements has been verified.

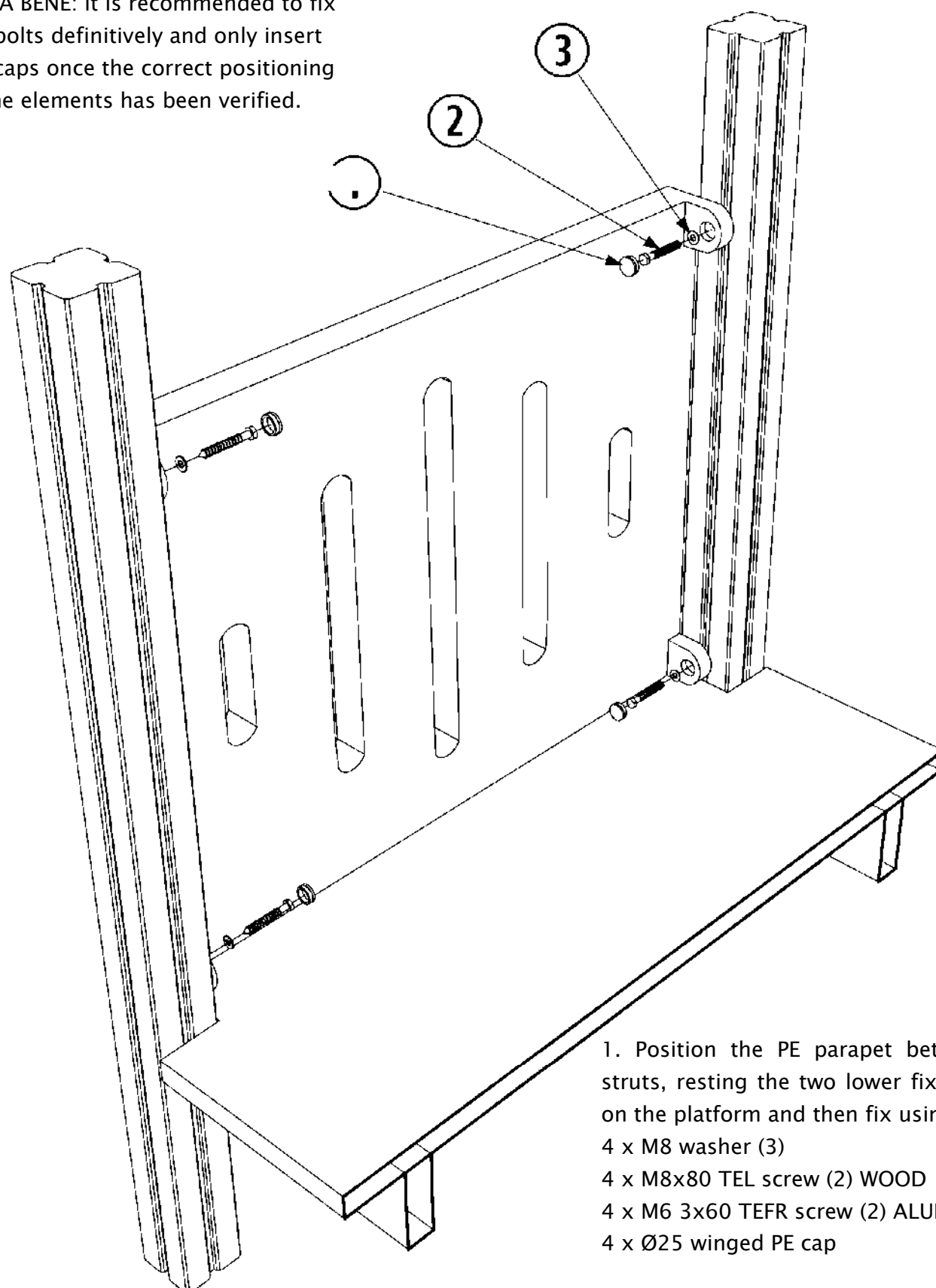

1. Position the PE parapet between the struts, resting the two lower fixing wings on the platform and then fix using:
 4 x M8 washer (3)
 4 x M8x80 TEL screw (2) WOOD
 4 x M6 3x60 TEFR screw (2) ALUMINIUM
 4 x Ø25 winged PE cap

2. If necessary, repeat the operation on the other parapets.

Le misure sono espresse in cm.	SOLZSOLZ	
Colori e modelli rappresentati sono puramente indicativi	denominazione e/o cliente :	istruzioni montaggio parapetto in Pe Max/Sultan/Oxi
firma esecutore : 	data : 16.06.2011	nr. pag. 1/1

Article num.	Default/Quantity	NAME
1	1	Aladin tower
2	1	Aladin PE archway
3	1	Curved slide h.84
4	4	ISO7089 Ø8 washer
5	4	M8x180 TORX screw
6	4	PE cap

1. After having fixed the PE archway (2), place the body of the curved slide (3) on the platform of the tower (1) and insert the bolts, necessary for fixing, into the holes present on the slide (3).
2. Check correct positioning, verticality and parallelism. Fix the bolts definitively and position the caps.
3. Repeat the operation also on the other side of the slide.

NOTE: COLOURS AND MODELS
REPRESENTED ARE PURELY
INDICATIVE

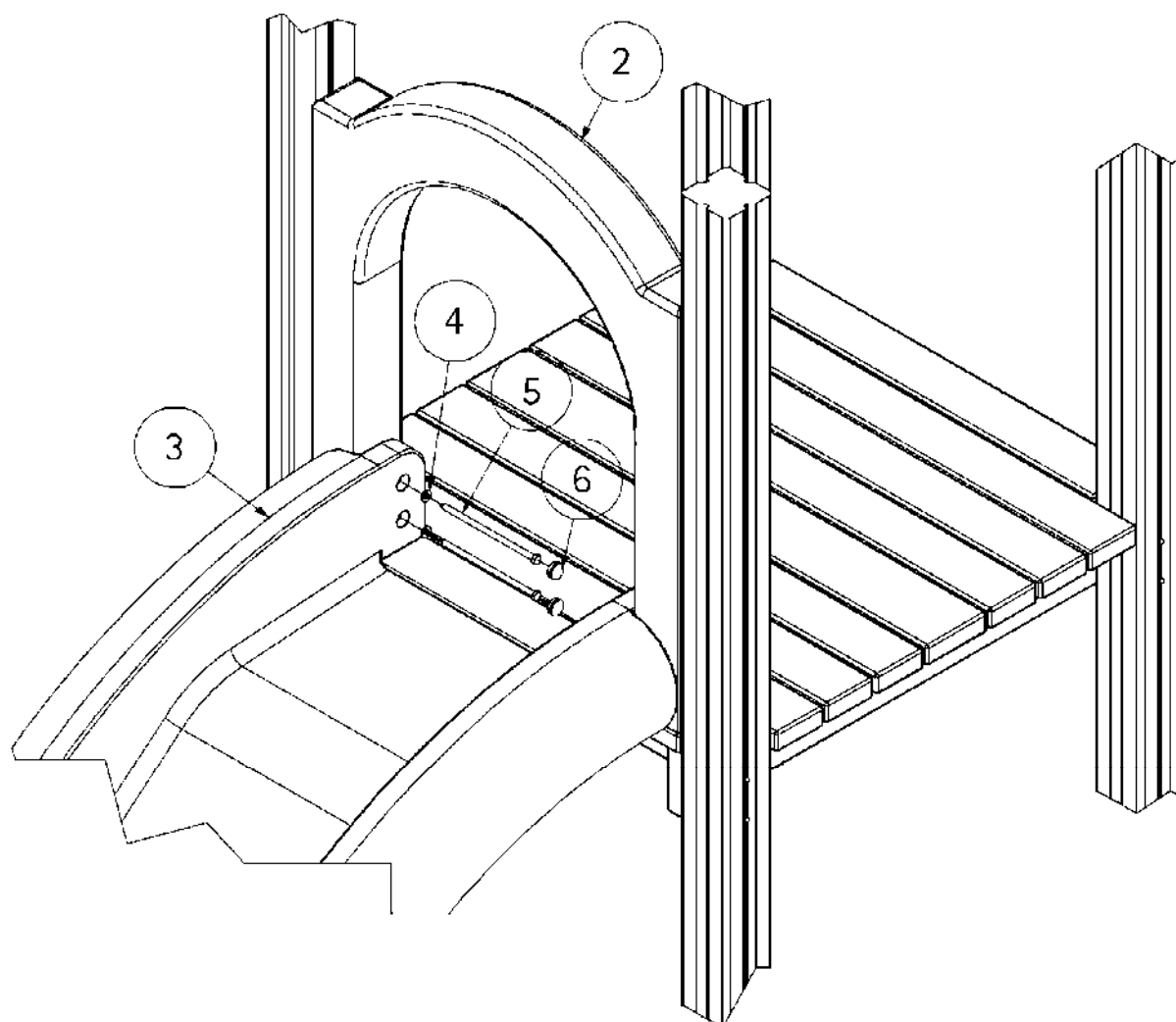

Le misure del disegno sono espresse in cm.		
Tolleranze generali applicate: *sezione/diametro legname impregnato $\pm 0,5$ (cm) *lunghezza legname impregnato $\pm 0,1$ (lung. totale) *lavorazioni legname impregnato $\pm 0,2$ (cm) *componenti in metallo ± 1 (mm) *componenti in altri materiali plastici $\pm 1,5$ (mm)	denominazione e/o cliente:	istruzioni di montaggio scivolo curvo pe con entrata in linea ALADIN - MAX - SULTAN - OXI - OASIS
firma esecutore: <i>Altieri</i>	data: 03.03.2011	nr. pag. 1/1

NOTA BENE: it is recommended to fix the bolts definitively and only insert the caps once the correct positioning of the elements has been verified.

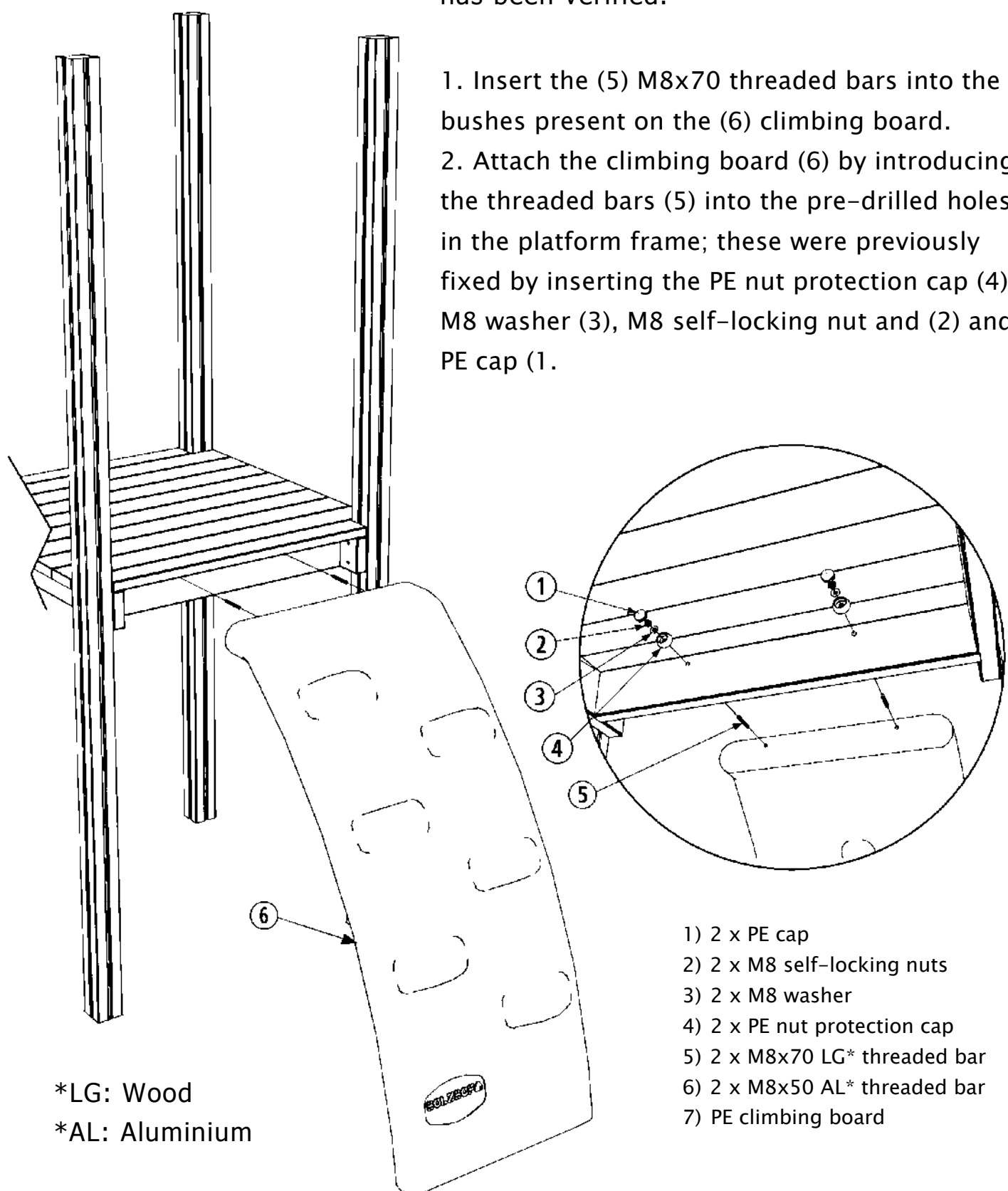

*LG: Wood
*AL: Aluminium

- 1) 2 x PE cap
- 2) 2 x M8 self-locking nuts
- 3) 2 x M8 washer
- 4) 2 x PE nut protection cap
- 5) 2 x M8x70 LG* threaded bar
- 6) 2 x M8x50 AL* threaded bar
- 7) PE climbing board

Le misure sono espresse in cm.		SOLZBO	
Colori e modelli rappresentati sono puramente indicativi La pedana di risalita può essere da 84 o 144 cm Il pianale rappresentato è indicativo	denominazione e/o cliente :	istruzioni di montaggio	
		Pedana di risalita Pe Max / Sultan / Aladin / oxi	
firma esecutore :	data : 17.06.2011	nr.	pag.1

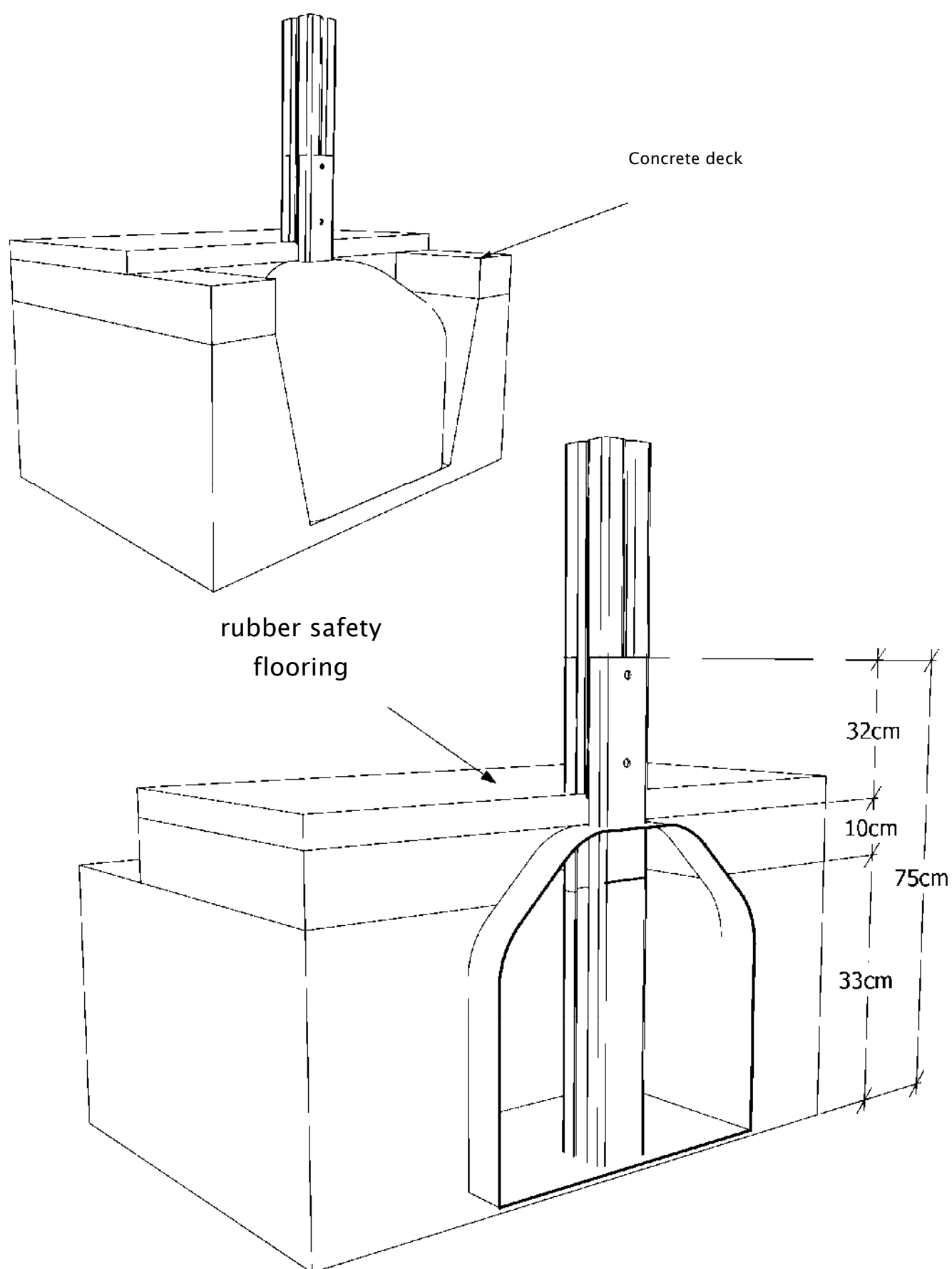

Le misure sono espresse in cm.	SOLZBO		
Colori e modelli rappresentati sono puramente indicativi	denominazione e/o cliente :	istruzioni montaggio interro montanti	
firma esecutore :	data : 15.02.2011	nr.	pag. 1/1

1. Excavate a hole with diameter of 30 cm and depth of 60 cm

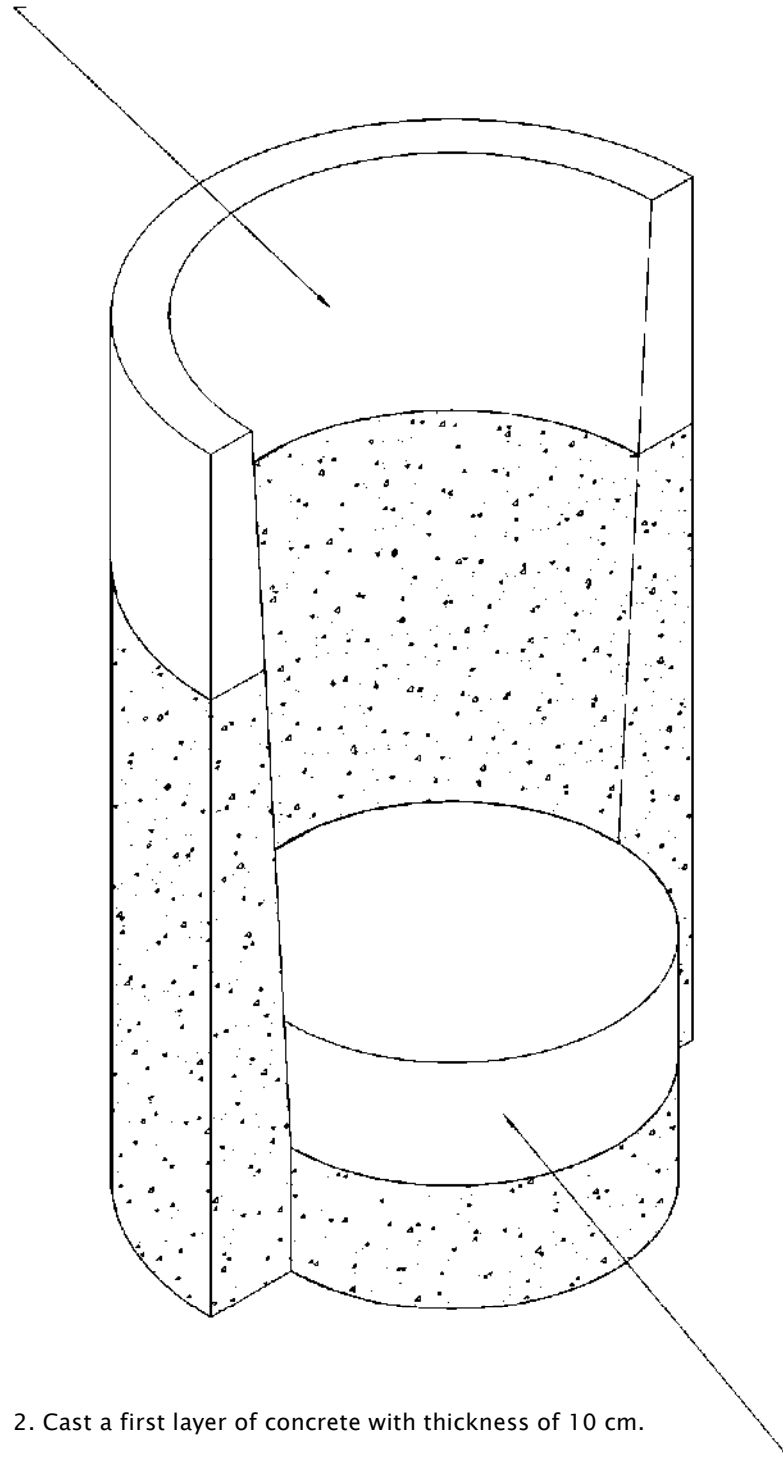

2. Cast a first layer of concrete with thickness of 10 cm.

Le misure del disegno sono espresse in cm		HOLZOF	
<small>Tolleranze generali applicate: *Sezione/diametro legname impregnato ± 0.5 (cm) *Lunghezza legname impregnato 19x119x102 (cm) *Lavorazioni legname impregnato ± 0.2 (cm) *Componenti in metallo ± 1 (mm) *Componenti in altri materiali plastici ± 1.5 (mm)</small>		denominazione e/o cliente:	Istruzioni di montaggio interro scivolo curvo Pe
firma esecutore:	Altieri	data:	31.05.05 nr. Pag. 1

3. When the concrete has set, position the slide bracket in the excavation hole, checking the correct alignment of the lower part of the slide with the finished ground level.

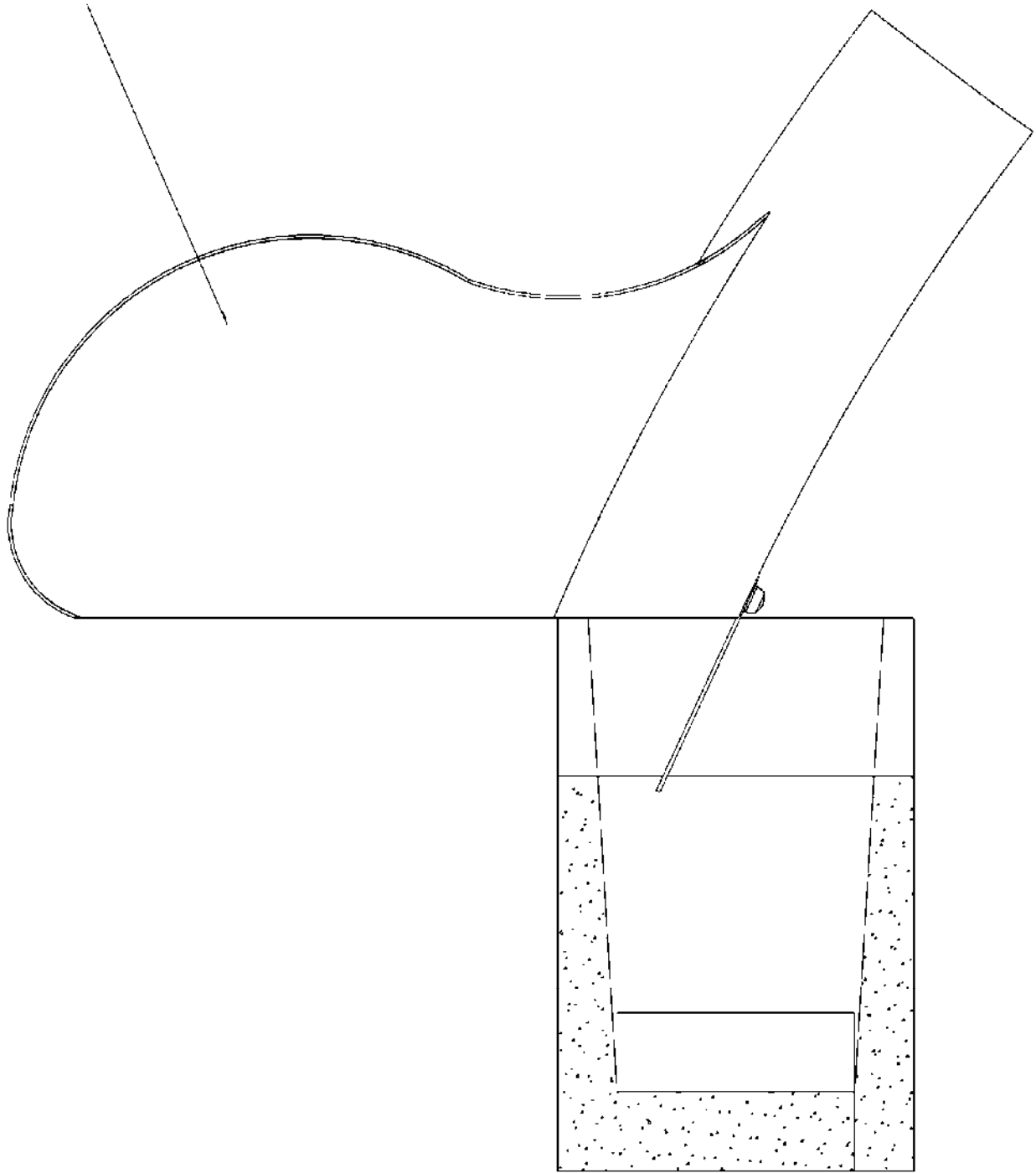

Le misure del disegno sono espresse in cm		HOLZHOFF	
Tolleranze generali applicate: *Sezione/diametro legname impregnato ± 0,5 (cm) *Lunghezza legname impregnato 19a/lung. totale *Lavorazioni legname impregnato + 0,2 (cm) *Componenti in metallo ± 1 (mm) *Componenti in altri materiali plastici ± 1,5 (mm)		denominazione e/o cliente:	Istruzioni di montaggio interro scivolo curvo Pe
firma esecutore:	Altieri	data:	31.05.05
		nr.	Pag. 2

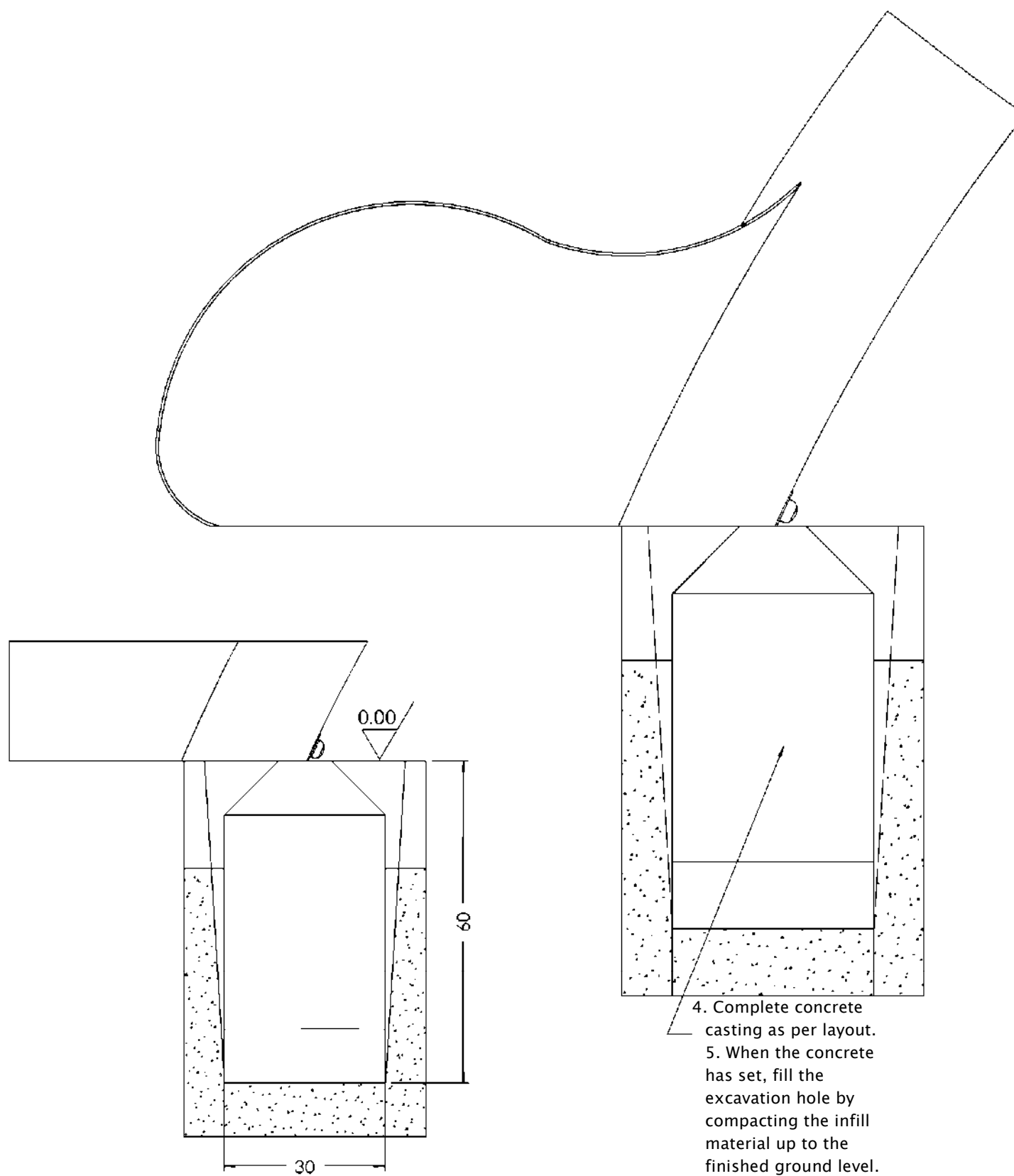

Le misure del disegno sono espresse in		HOLZHOFF	
Tolleranze generali applicate: *Sezione/diametro legno impregnato ± 0.5 (cm) *Lunghezza legno impregnato ± 0.2 (cm) *Lavorazioni legno impregnato ± 0.2 (cm) *Componenti in metallo ± 1 (mm) *Componenti in altri materiali plastici ± 1.5 (mm)		denominazione e/o cliente:	Istruzioni di montaggio interro scivolo curvo Pe
firma esecutore:	Altieri	data:	31.05.05
		nr.	Pag. 3

1. Attach the brackets (1) by introducing the following in sequence: PE nut protection cap (2), M8 washer (3), M8x25 HEX screw (4), PE cap (5).

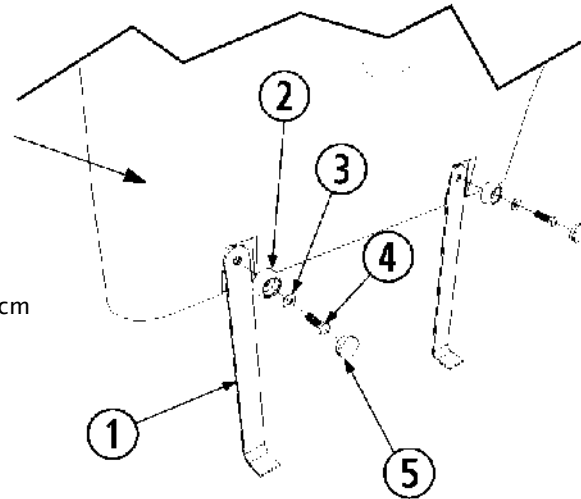

NOTA BENE: it is recommended to fix the bolts definitively and only insert the caps once the correct positioning of the elements has been verified.

1. Excavate two holes with diameter of 30 cm and depth of 60 cm

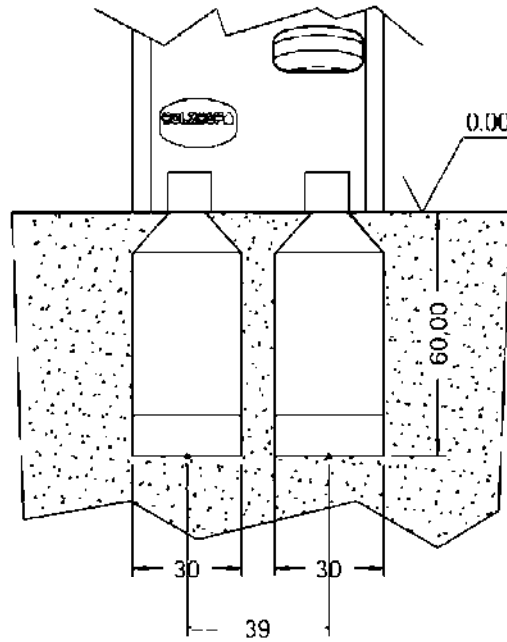
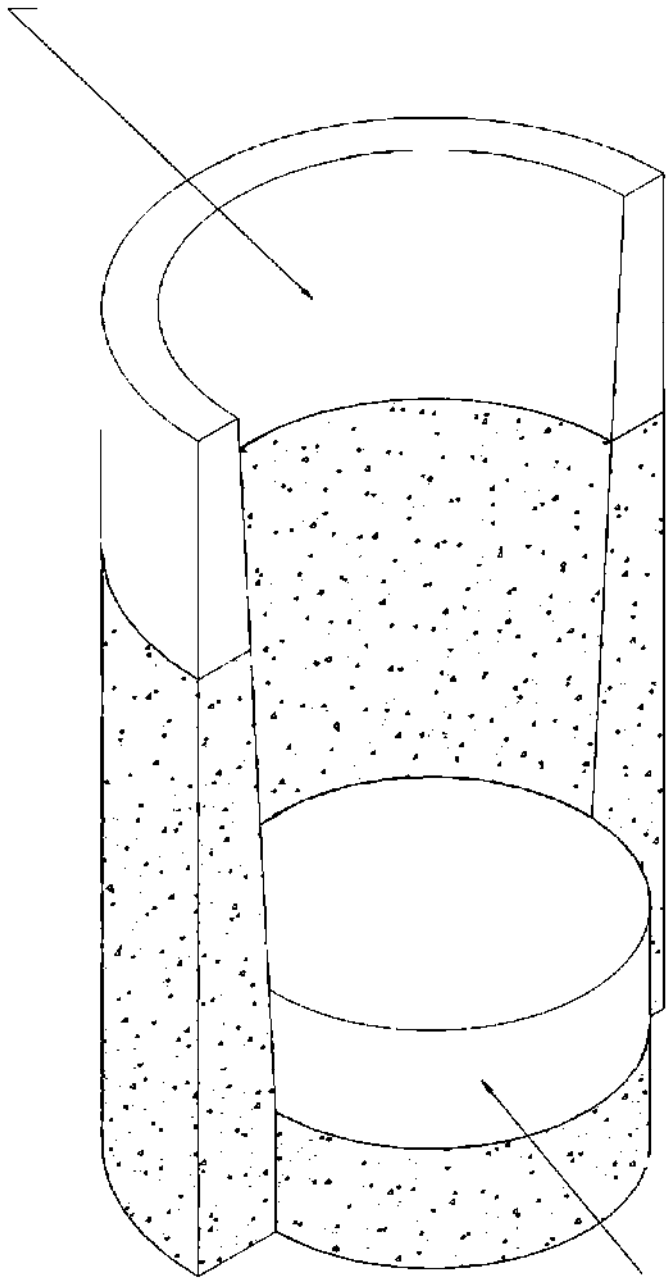

3. When set, position the climbing board brackets in the excavation hole, checking the correct alignment of the lower part of the platform with the level of the finished ground level.

4. Complete concrete casting as per layout.

5. When the concrete has set, fill the excavation hole by compacting the infill material up to the finished ground level.

2. Cast a first layer of concrete with thickness of 10 cm.

Le misure sono espresse in cm.	SOLZOO	
Colori e modelli rappresentati sono puramente indicativi	denominazione e/o cliente :	istruzioni di montaggio interro pedana di risalita Pe
firma esecutore : 	data : 15.02.2011	nr. pag.1

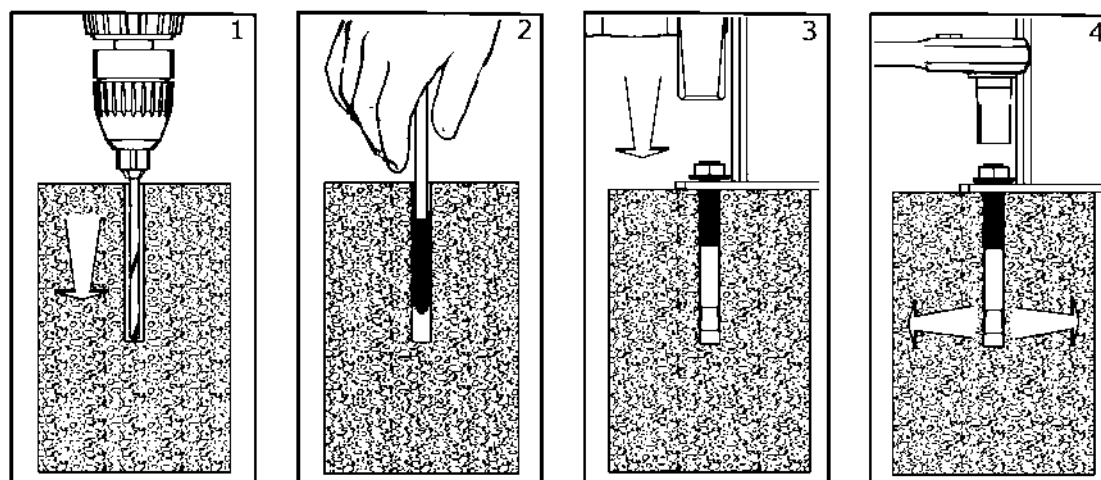

1. Drill.
2. Clean the hole thoroughly using an air pump and small brushes.
3. Insert the anchor into the hole present on the bracket with the aid of a hammer.
4. Tighten using dynamometric wrench.

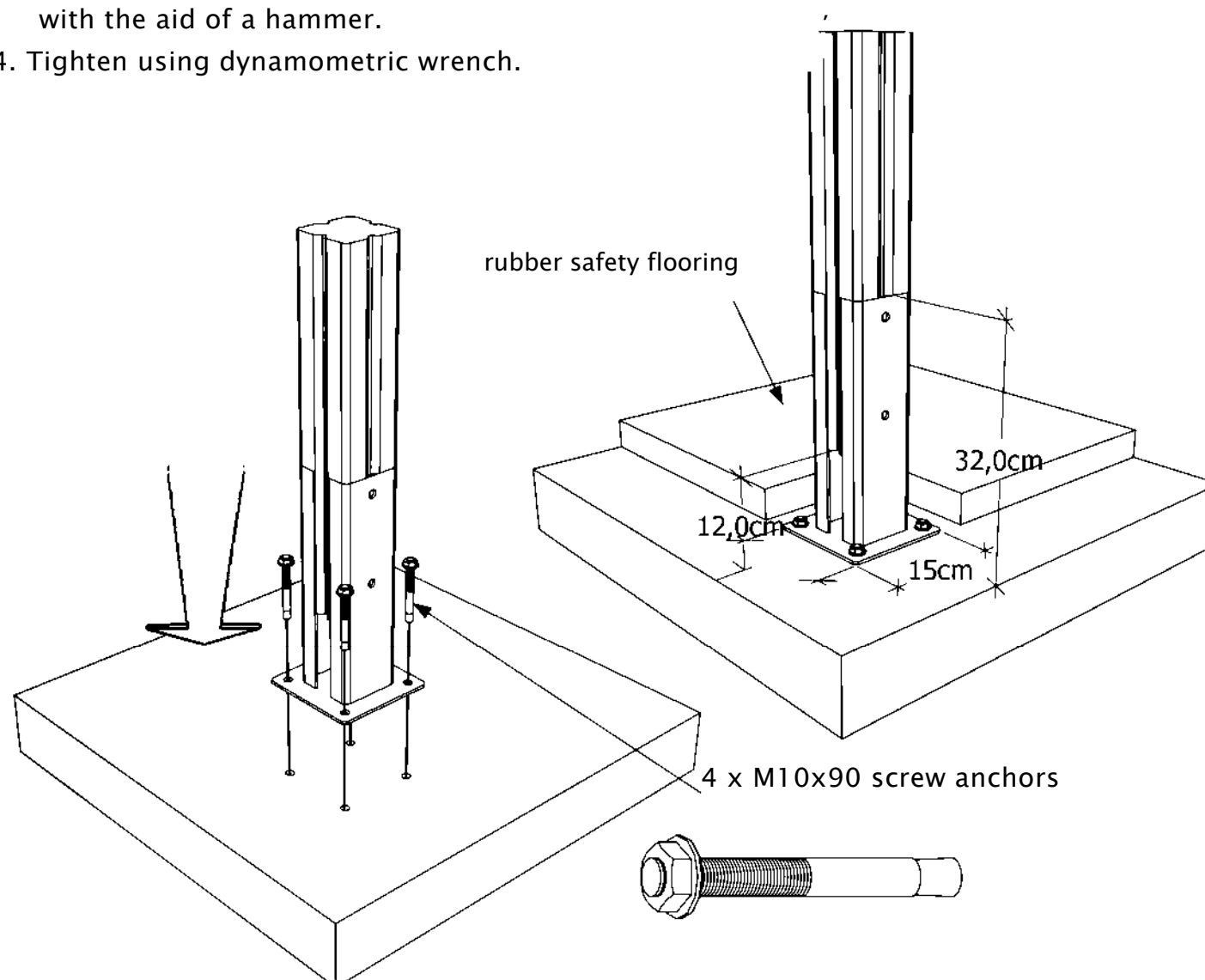

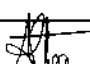
Le misure sono espresse in cm.	SOLZROE	
Colori e modelli rappresentati sono puramente indicativi	denominazione e/o cliente :	istruzioni di montaggio ancoraggio montanti con staffe
firma esecutore : 	data : 14.02.2011	nr. pag.1

Article num.	Quantity	CODE N.	NAME
1	1	xfe265	59x59x35 stainless steel angle bracket
2	2	xpe10	PE nut protection cap
3	2	xpe116	PE cap
4	1	-	M10 self-locking nut
5	1	-	M8x115 screw anchor
6	1	-	Ø10 washer

1. Position the slide on the support surface, marking the position of the screw anchor.
2. Drill the support surface and position the screw anchor.
3. Fix the angle bracket to the support surface using the relevant bolts, as indicated in the figure.

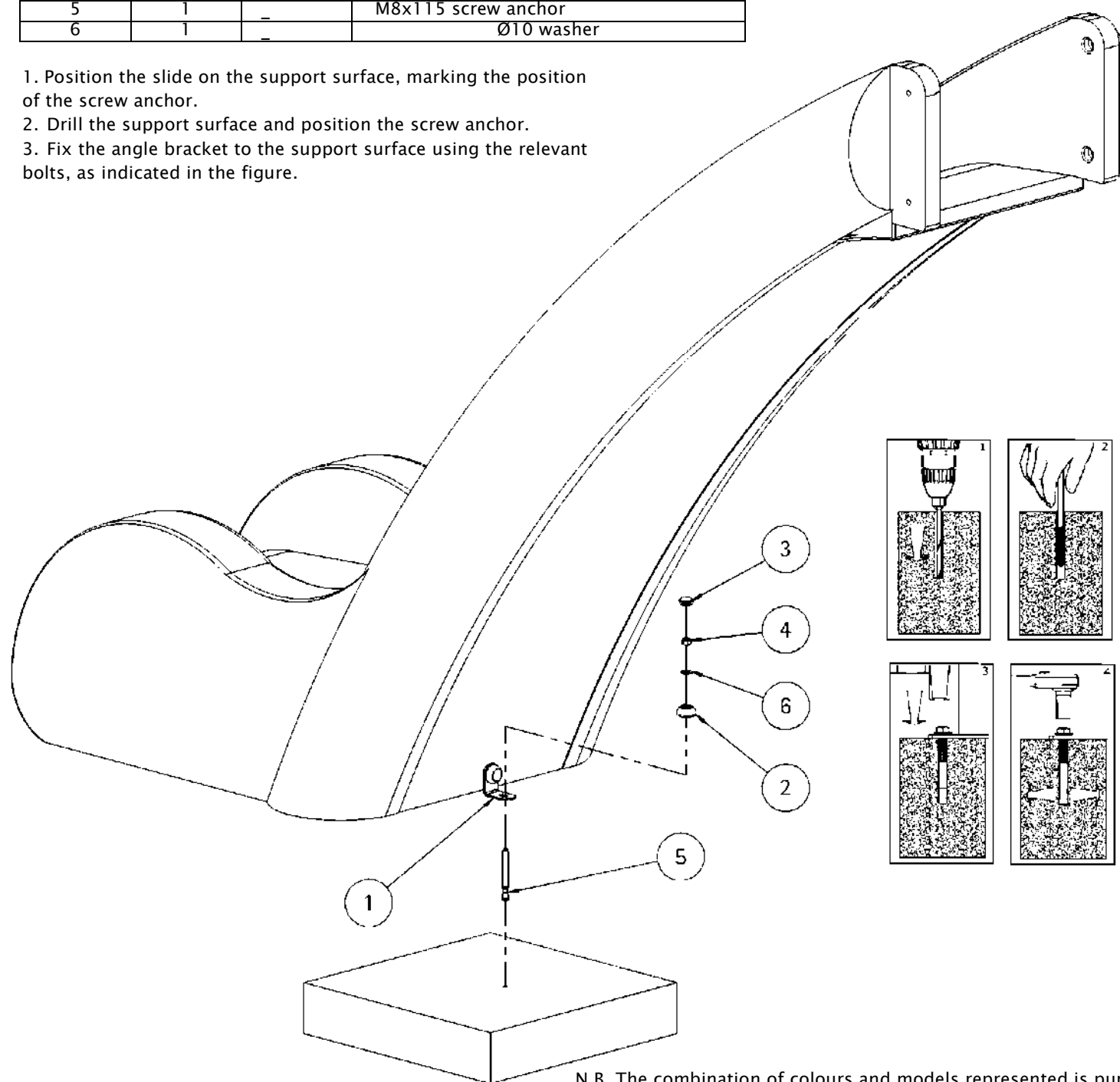

N.B. The combination of colours and models represented is purely indicative.

The slide can be at a height of 84-144-192 cm.

Le misure del disegno sono espresse in cm	HOLZHOFF		
Tolleranze generali applicate: *Sezione/diametro legname impregnato ± 0.5 (cm) *Lunghezza legname impregnato ± 0.1 (cm) *Lavorazioni legname impregnato ± 0.2 (cm) *Componenti in metallo ± 1 (mm) *Componenti in altri materiali plastici ± 1.5 (mm)	denominazione e/o cliente:	istruzioni di montaggio ancoraggio scivolo curvo pe	
firma esecutore: <i>Altieri</i>	data: 16.02.2011	nr.	pag.1

Article num.	Quantity	CODE N.	NAME
1	2	xpe10	PE nut protection cap
2	2	xpe116	PE cap
3	1	-	PE climbing board
4	2	xfe265	59x59x35 stainless steel angle bracket
5	2	-	M10 self-locking nut
6	2	-	Ø10 washer
7	2	-	M8x115 screw anchor

1. Position the climbing board on the support surface and mark the position of the screw anchors.
2. Drill the support surface and position the screw anchors.
3. Fix the angle brackets to the support surface using the relevant bolts, as indicated in the figure.

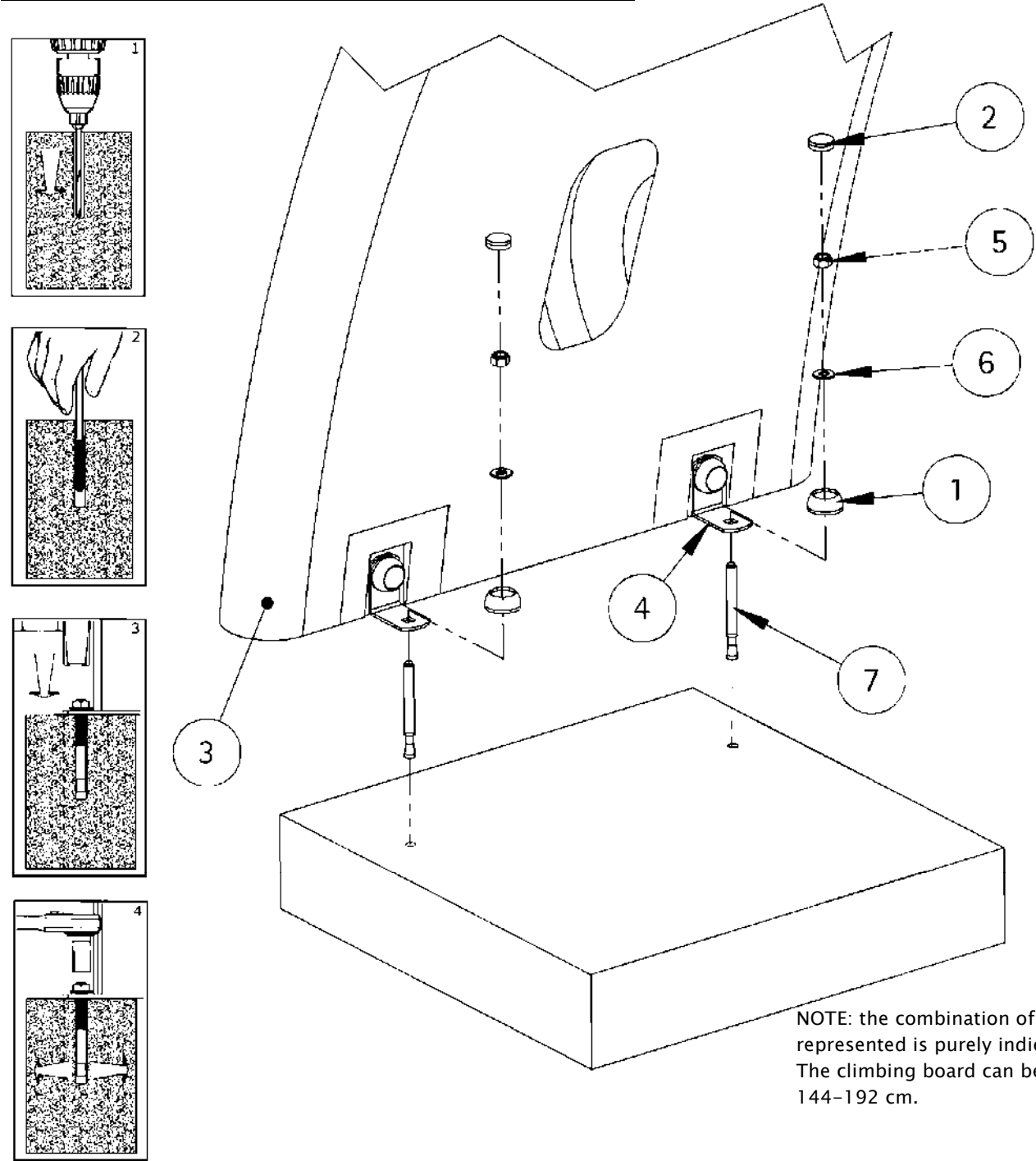

NOTE: the combination of colours and models represented is purely indicative.
The climbing board can be at a height of 84–144–192 cm.

Le misure del disegno sono espresse in cm		HOLZEP	
Tolleranze generali applicate: *Sezione/diametro legname impregnato ± 0.5 (cm) *Lunghezza legname impregnato 19% (lung. totale) *Lavorazioni legname impregnato + 0.2 (cm) *Componenti in metallo ± 1 (mm) *Componenti in altri materiali plastici ± 1.5 (mm)		denominazione e/o cliente:	istruzioni di montaggio ancoraggio pedana di risalita in Pe
firma esecutore:	Altieri	data:	19.06.06 nr. pag. 1