

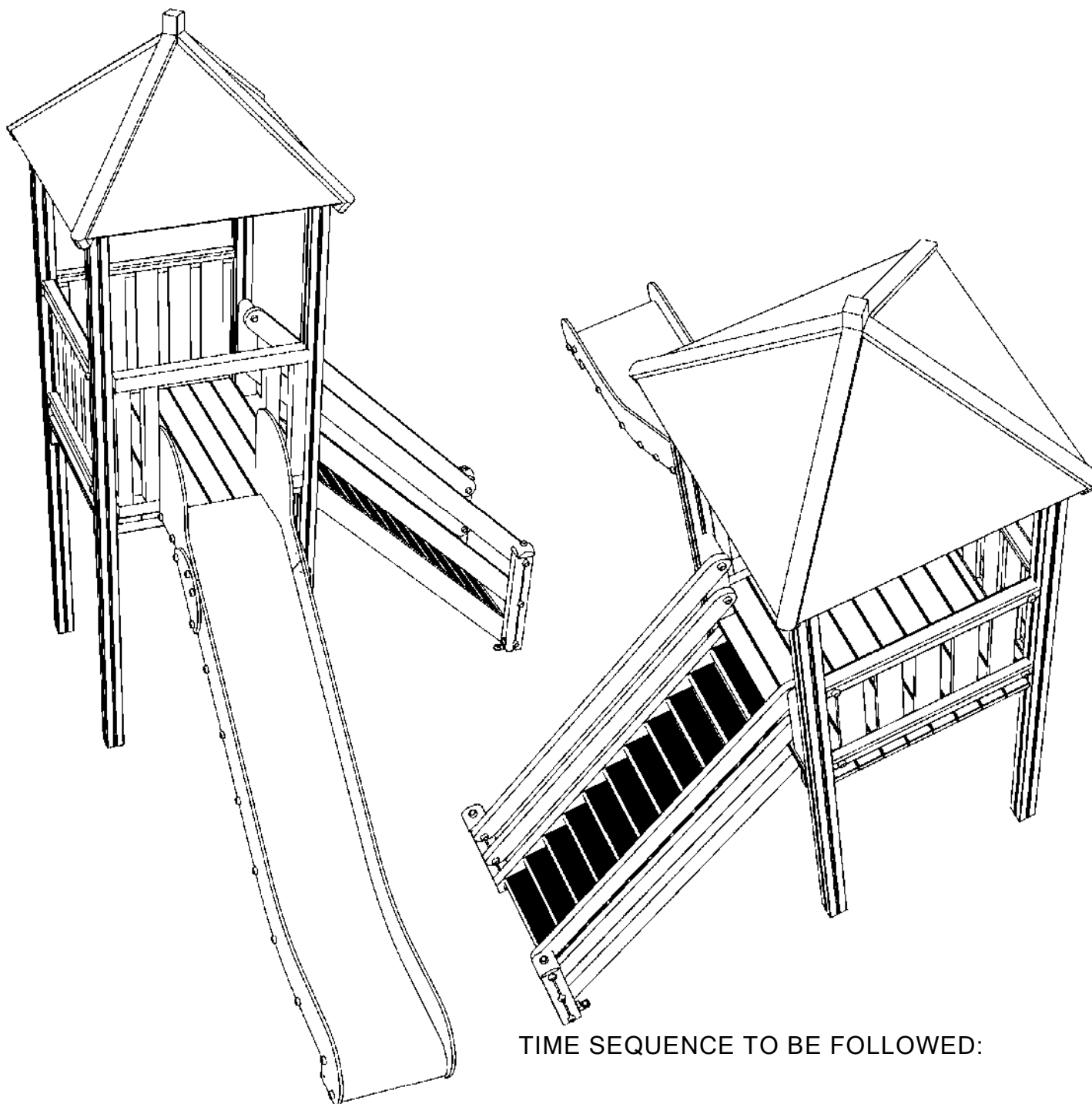

MAX XM 100 L PUR  
line assembly  
instructions



TIME SEQUENCE TO BE FOLLOWED:

1. STRUTS AND PLATFORMS
2. PARAPETS
3. SLIDE
4. STEPS
5. ROOF
6. UNDERGROUND LAYING/ANCHORAGE OF THE STRUCTURE

Le misure sono espresse in cm.	SOLZOO	
Colori e modelli rappresentati sono puramente indicativi	denominazione e/o cliente :	istruzioni di montaggio linea MAX XM 100 L PUR
firma esecutore : 	data : 30.06.2011	nr. pag. 1/1

Article num.	fixing	CODE N.	NAME
1	2	xpe11	Shaped PE nut protection cap
2	2	xpe10	PE nut protection cap
3	4	xpe116	PE cap
4	4	-	ISO7089 Ø8 washer
5	2	-	UNI7473 M8 self-locking nut
7	2	-	UNI4017 M8X155 HEX SCREW

NOTA BENE: it is recommended to fix the bolts definitively and only insert the caps once the correct positioning of the elements has been verified.

**NOTE:**

- The colours and models in the image are purely indicative.
- The platform can be in engineered wood or wooden planking.

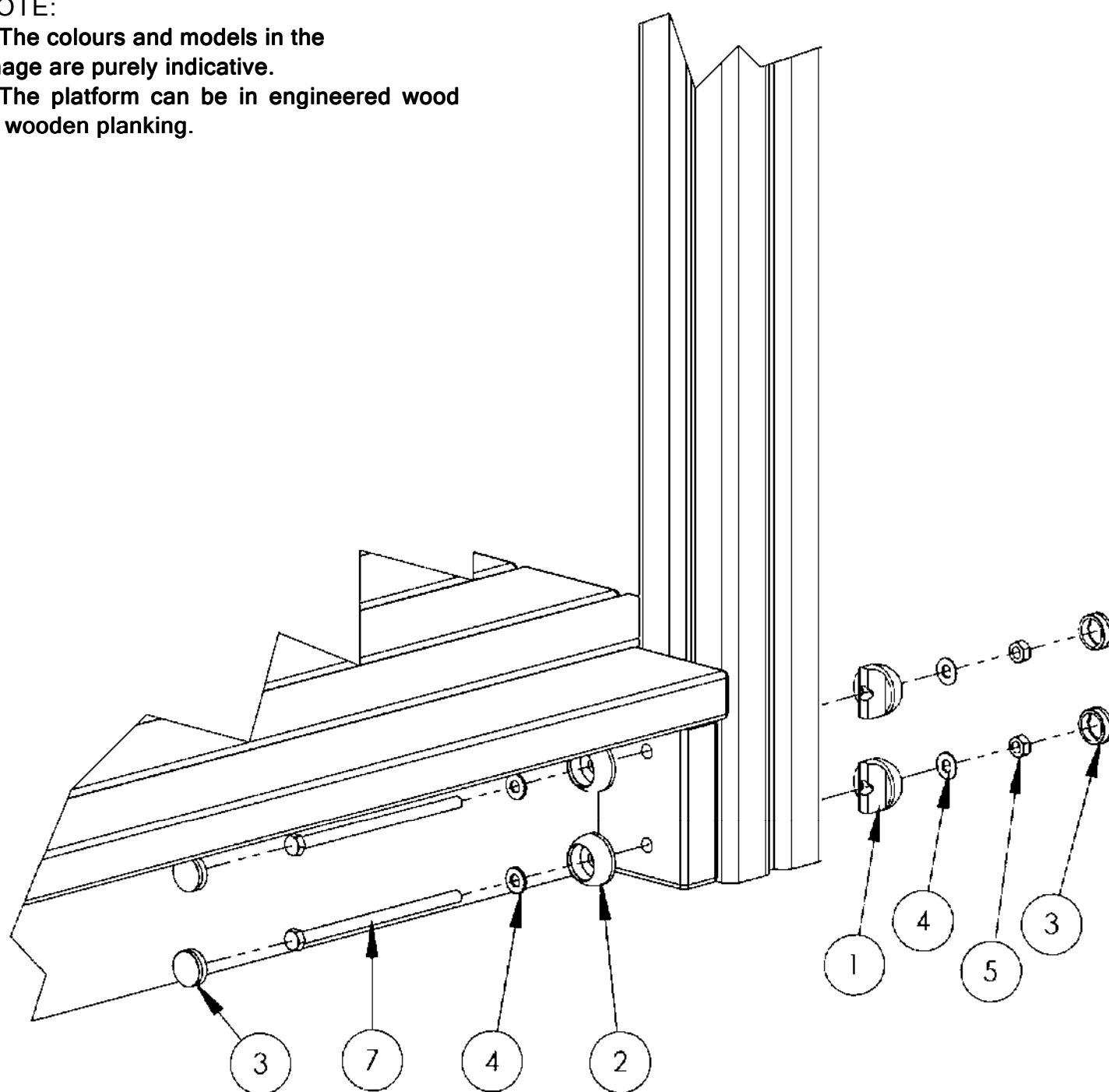



Le misure sono espresse in cm.	SOLZOO		
Colori e modelli rappresentati sono puramente indicativi	denominazione e/o cliente :	istruzioni di montaggio montanti e pianali	
firma esecutore :	data : 16.02.2011	nr.	pag.1/1

1. Position the parapet between the two struts at 7 cm in height from the platform
2. Check the correct parallelism and verticality between struts and platform.
3. Insert the nuts and bolts necessary for fixing, as indicated in the figure.

Article num.	Quantity	CODE N.	NAME
1	4	xpe10	PE nut protection cap
2	4		ISO7089 Ø8 washer
3	4		UNI704 M8x80 TEL SCREW
4	4	xpe116	PE cap
5	4	xfe275	stainless steel angle bracket

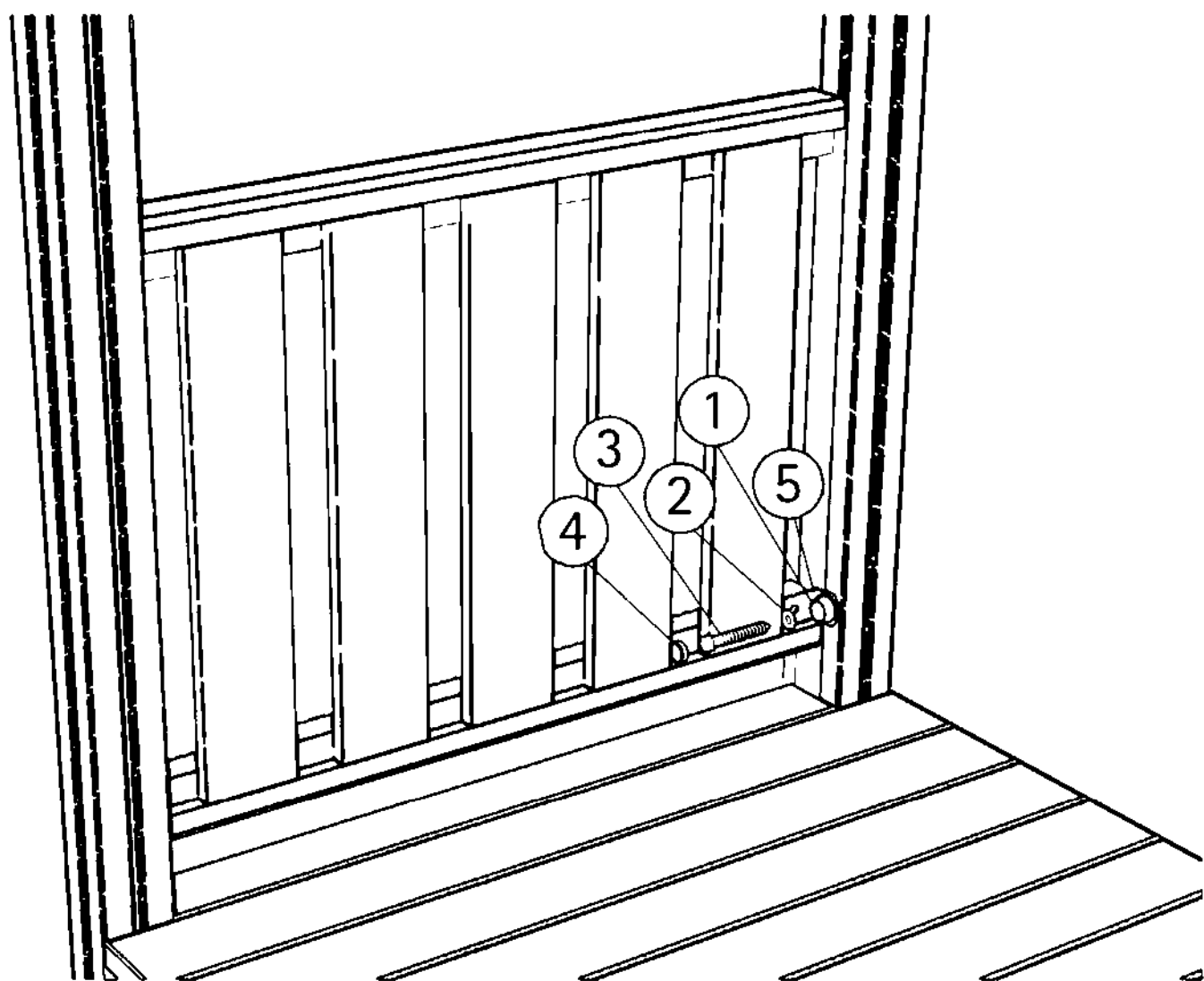
**NOTA BENE:** it is recommended to fix the bolts definitively once the correct positioning of the elements has been verified.



Le misure sono espresse in cm.		
Colori e modelli rappresentati sono puramente indicativi	denominazione e/o cliente :	istruzioni di montaggio parapetto il legno linea Max
firma esecutore : 	data : 30.06.2011	nr. pag.1/1

1. Fix the slide archway (2) to the struts via the M6x140 TORX screws, inserting them into the pre-drilled holes present.

- 1) M6x140 TORX SCREW (4x)
- 2) Max wooden slide archway (1x)

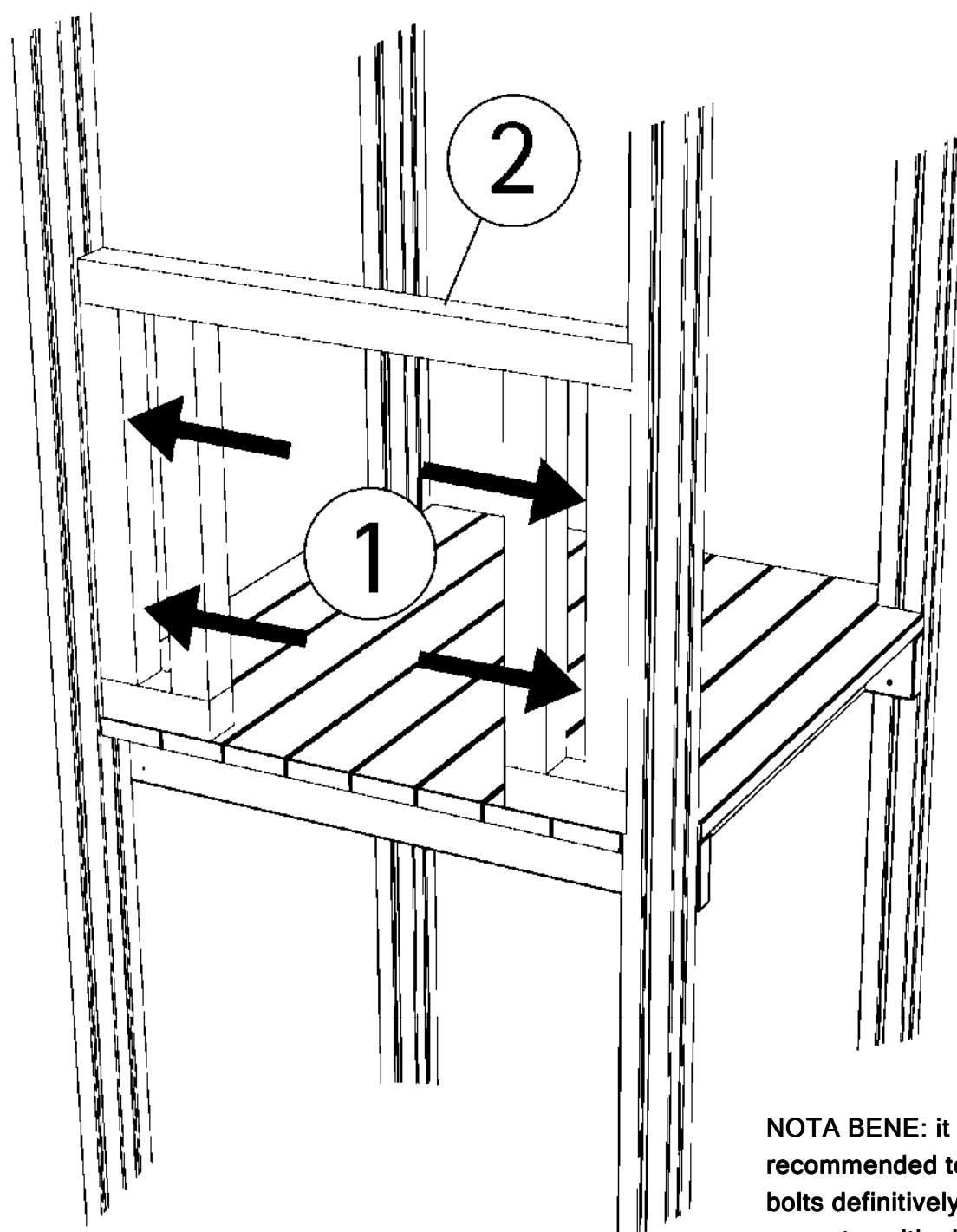

**NOTA BENE:** it is recommended to fix the bolts definitively once the correct positioning of the elements has been verified.

Le misure sono espresse in cm.	SOLZOO		
Colori e modelli rappresentati sono puramente indicativi	denominazione e/o cliente :	istruzioni di montaggio scivolo Max in legno	
firma esecutore : 	data : 30.06.2011	nr.	pag.1/2

- 1) M6x80 TORX screw (2x)  
2) Max wooden slide body (1x)

1. Fix the slide (2) to the archway using the M6x80 TORX screws, to be inserted into the pre-drilled holes.

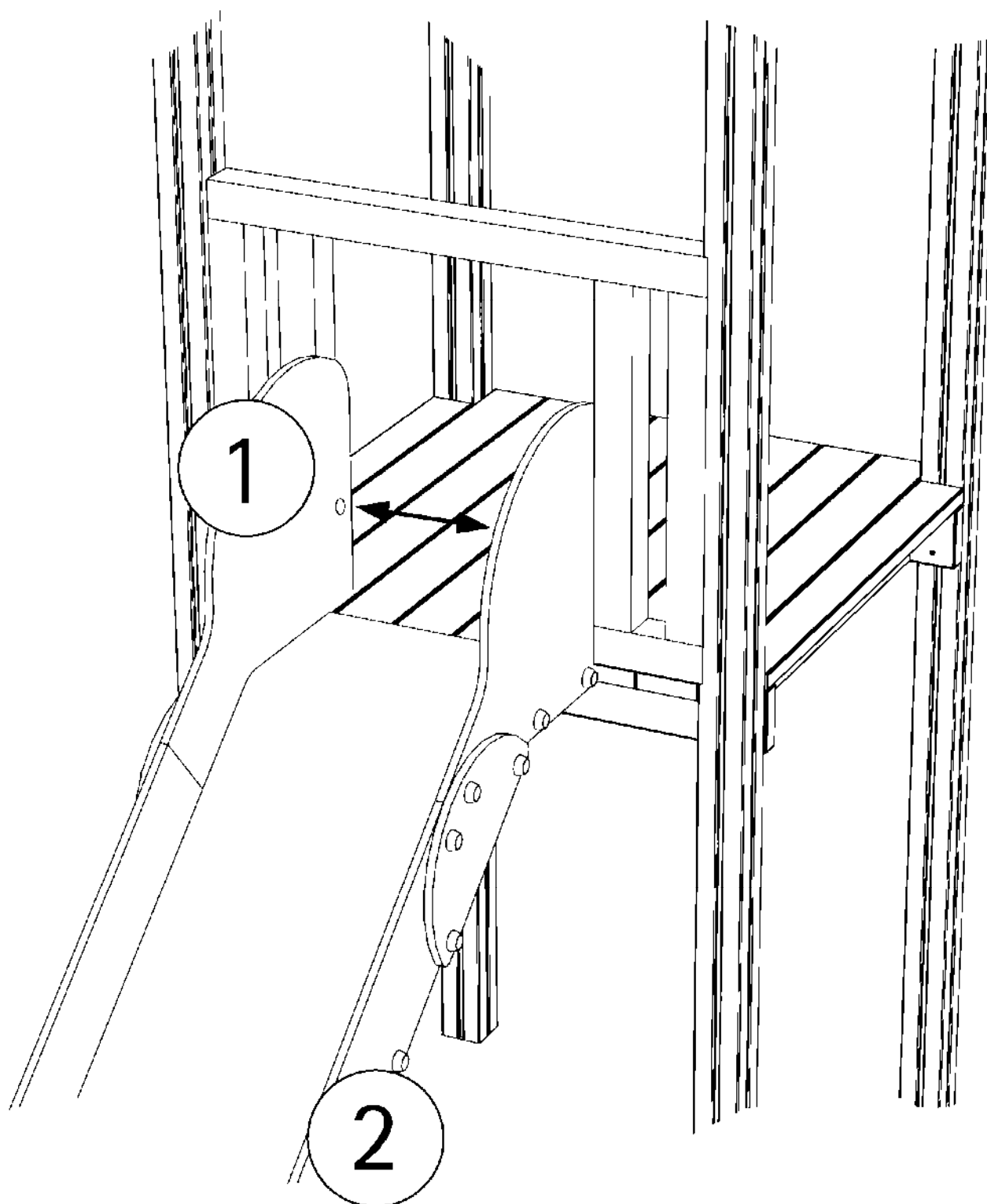

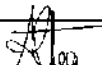
Le misure sono espresse in cm.	SOLZOO		
Colori e modelli rappresentati sono puramente indicativi	denominazione e/o cliente :	istruzioni di montaggio scivolo Max in legno	
firma esecutore : 	data : 30.06.2011	nr.	pag.2/2

Article num.	support 01/Quantity	CODE N.	NAME
1	1	-	Side panels with wooden steps assembled
2	4	xpe10	PE nut protection cap
3	4	xpe116	PE cap
4	2	-	UNI4017 M8X150 HEX SCREW
5	4	-	IS07089 Ø8 washer
6	2	-	UNI7473 M8 self-locking nut
7	2	xlls104	Small strut for steps

1. Position the first small strut (7) at the inner lower part of the steps side panel (1), without fixing it completely; using the bolts as indicated in the figure.

2. Repeat the same procedure for the second (8) small strut on the other side.

DO NOT FIX THE BOLTS COMPLETELY AND DO NOT POSITION THE CAPS IN THIS PHASE.

COLOURS AND MODELS REPRESENTED ARE PURELY INDICATIVE.  
THE STEPS CAN MEASURE 84 - 144 - 192 cm. IN HEIGHT.

NOTA BENE: it is recommended to fix the bolts definitively and only insert the caps once the correct positioning of the elements has been verified.

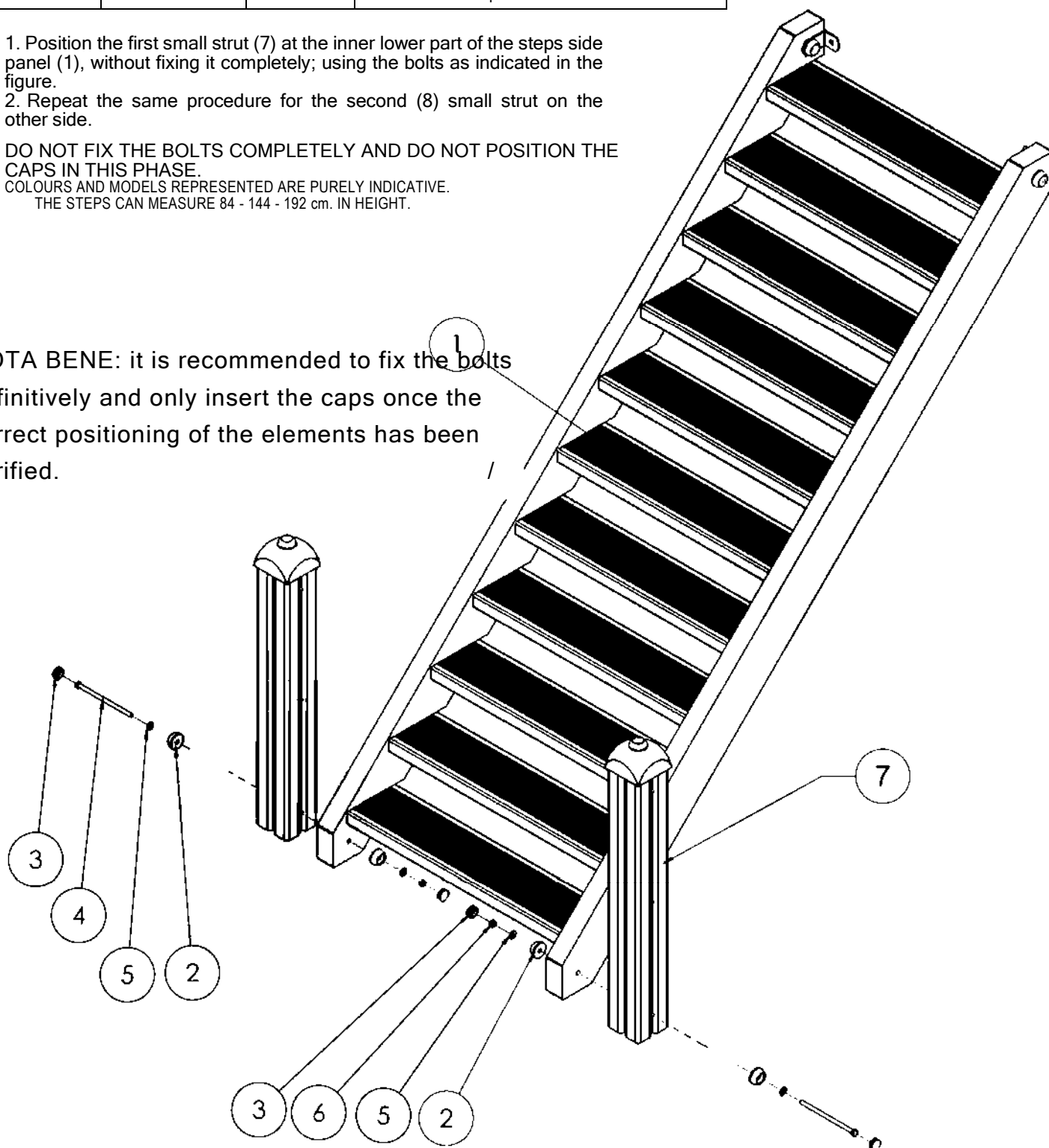



Le misure sono espresse in cm.	SOLZOO	
Colori e modelli rappresentati sono puramente indicativi	denominazione e/o cliente :	istruzioni di montaggio scala a gradini linea MAX / SULTAN
firma esecutore :	data : 28.06.2011	nr. pag.1/3

Article num.	underground 02/ Quantity	NAME
1	4	PE nut protection cap
2	4	PE cap
3	2	UNI4017 M8x65 HEX SCREW
4	4	ISO7089 Ø8 washer
5	2	UNI7473 M8 self-locking nut
6	1	Assembled frame table

1. Position the steps small struts in the previously excavated holes, moving the upper part of the steps towards the tower platform table (6).
2. Check that the angle brackets are in axis with the holes present on the table (6) and insert the bolts used for fixing as shown in the figure.

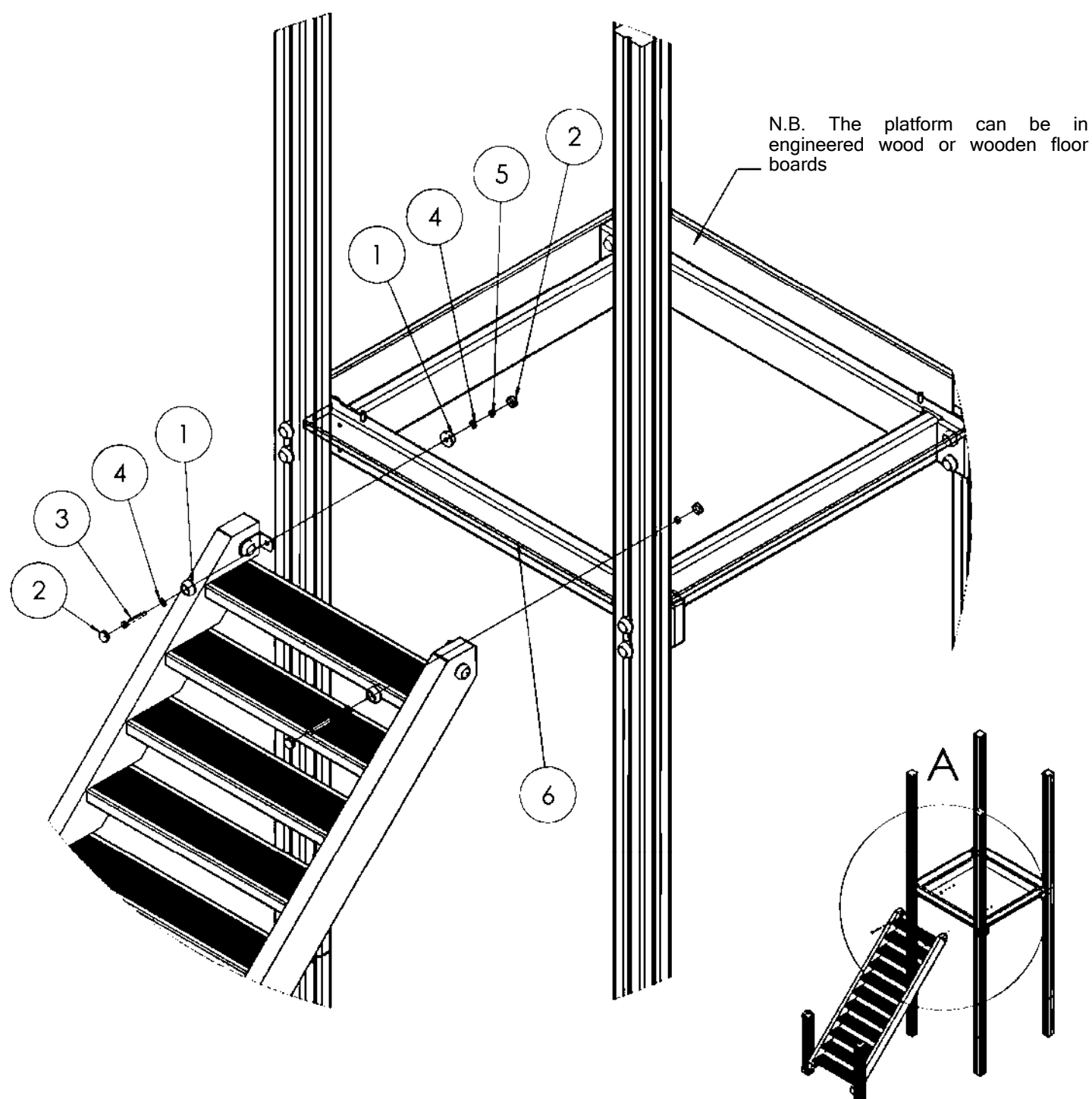
FIX THE BOLTS COMPLETELY BUT DO NOT POSITION THE CAPS IN THIS PHASE.



Le misure sono espresse in cm.	SOLZOO	
Colori e modelli rappresentati sono puramente indicativi	denominazione e/o cliente :	istruzioni di montaggio scala a gradini linea MAX / SULTAN
firma esecutore : 	data : 28.06.2011	nr. pag.2/3



Article num.	support 03/ Quantity	CODE N.	NAME
1	2	xls68	Upper wooden shim
2	4	xls25	Wooden hand rail
3	4	xpe11	Shaped PE nut protection cap
4	4	-	UNI704 M8x220 TEL SCREW
5	4	-	UNI401 7 M8x140 HEX SCREW
6	12	-	IS07089 Ø8 washer
7	4	-	UNI7473 M8 self-locking nut
8	8	xpe10	PE nut protection cap
9	12	xpe116	PE cap

1. Position the first hand rail (2) at the inner lower part of the steps strut. Insert the bolts used for fixing as in the figure, without fixing it completely and without positioning the caps (9).
2. Position the wooden shim (1) on the tower platform strut, inserting the fixing bolts into the hole on the hand rail shim and in axis with the tower strut centre line, as indicated in the figure, without fixing it completely and without positioning the caps (4).
3. Repeat the same operations for the other three hand rails.
4. Fix the bolts definitively and position the caps (9), which were not positioned in the previous phases.

N.B. The platform can be in engineered wood or wooden floor boards

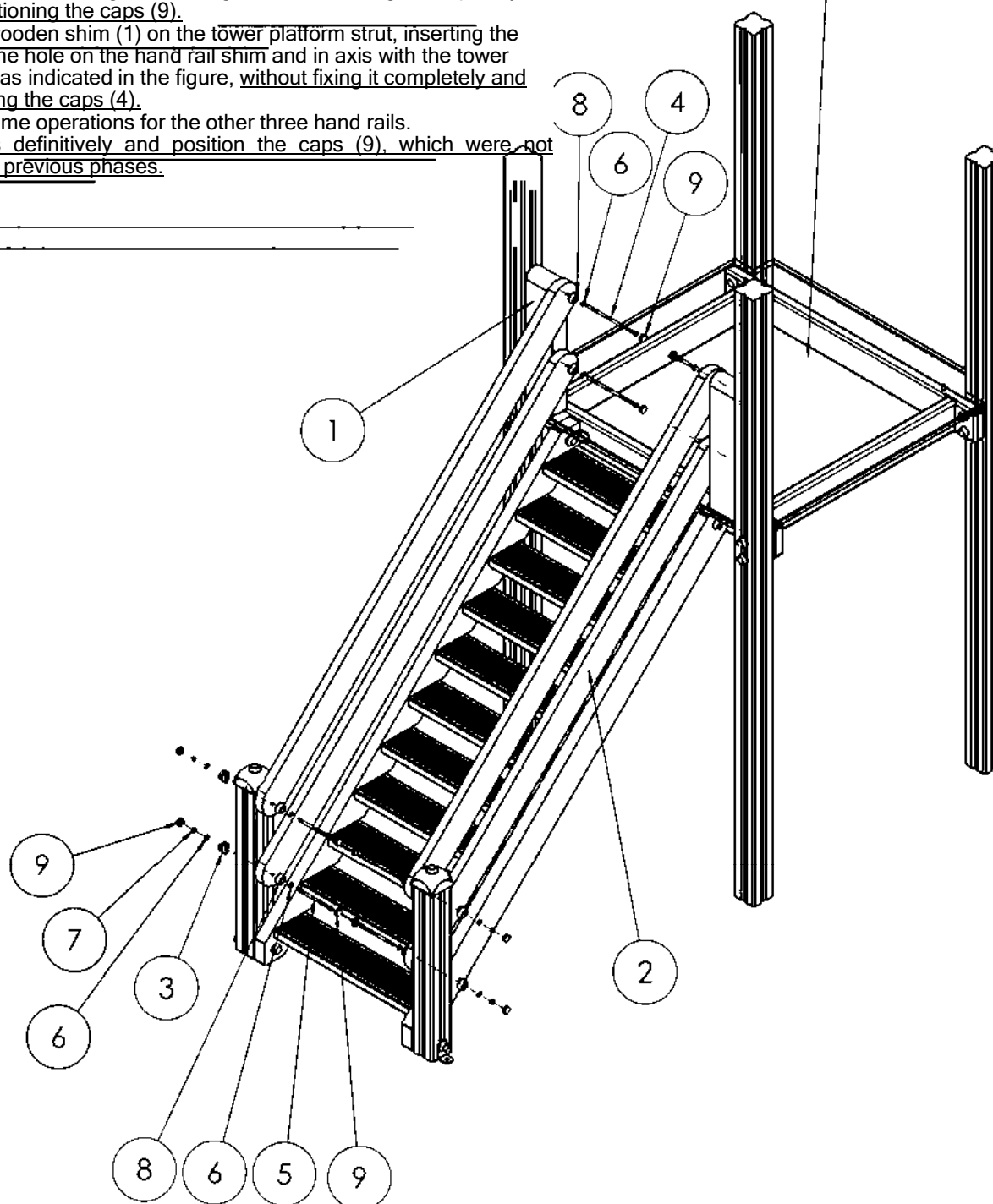

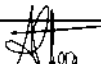
Le misure sono espresse in cm.		
Colori e modelli rappresentati sono puramente indicativi	denominazione e/o cliente :	<b>istruzioni di montaggio</b> <b>scala a gradini</b> <b>linea MAX / SULTAN</b>
firma esecutore : 	data : 28.06.2011	nr. pag.3/3

Article num.	Quantity	CODE N.	NAME
1	1	-	Max wooden roof
2	8	xpe10	PE nut protection cap
3	8	xpe116	PE cap
4	8	-	IS07089 Ø8 washer
5	4	-	M8x80 HEX SCREW
7	8	-	M8x60 HEX SCREW
8	4	xfea 115	Bracket for Max wooden roof

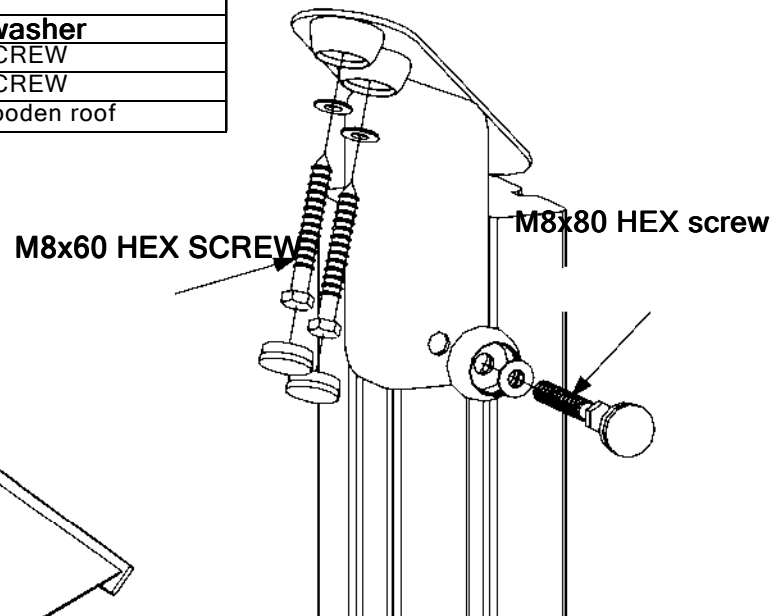
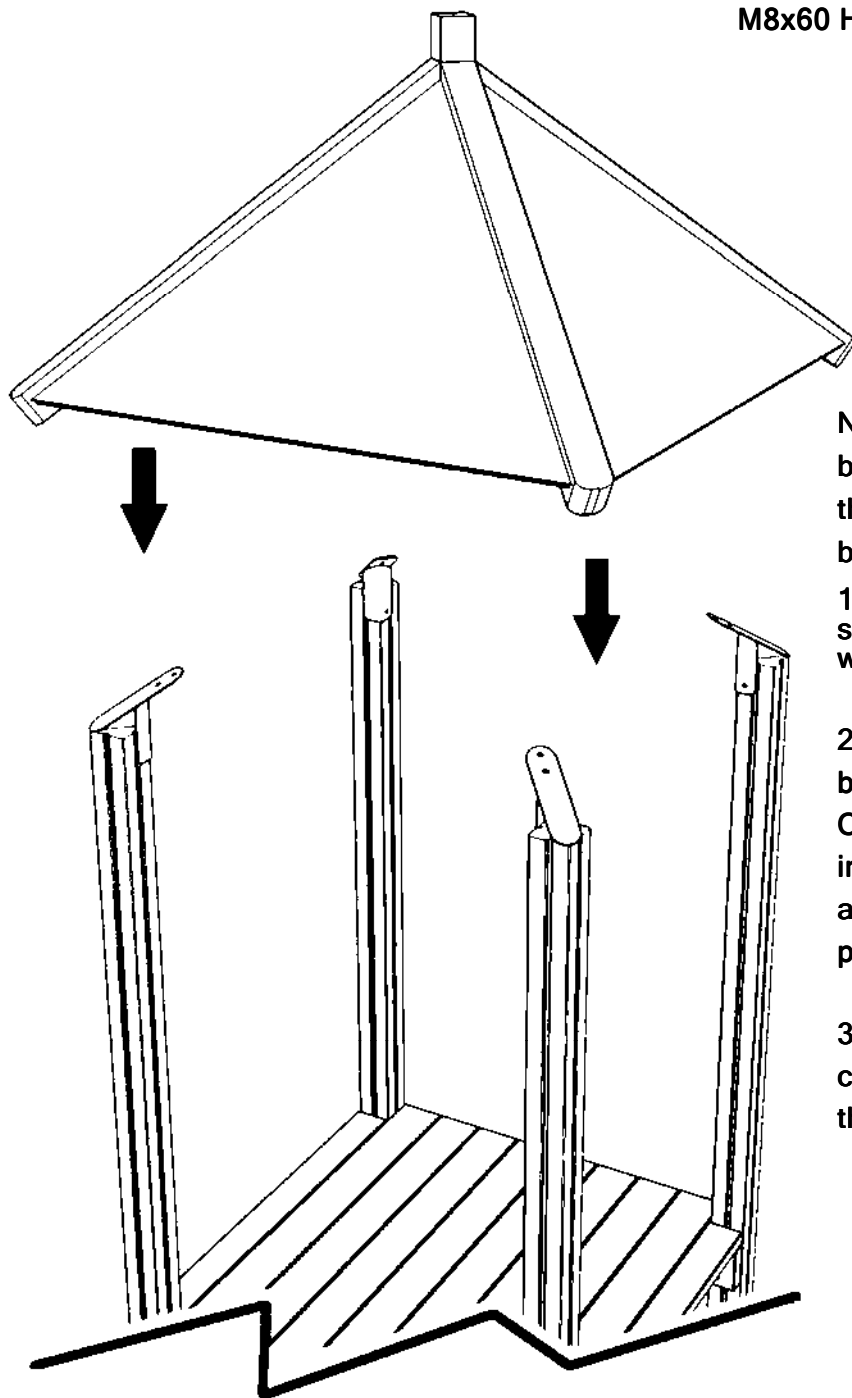

**NOTA BENE:** it is recommended to fix the bolts definitively and only insert the caps once the correct positioning of the elements has been verified.

1. Fix the 4 brackets to the upper end of the struts, inserting the nut protection cap, M8 washer and M8x80 HEX screw.

2. Position the roof by placing the small beams on the brackets.

Check that the roof is centred and then fix inserting the nut protection cap, M8 washer and M8x60 HEX screws into the two holes present in the bracket.

3. Check that everything is positioned correctly and then fix definitively and position the caps.

Le misure sono espresse in cm.	SOLZOO	
Colori e modelli rappresentati sono puramente indicativi	denominazione e/o cliente :	istruzioni di montaggio Linea MAX tetto in legno
firma esecutore : 	data : 30.06.2011	nr. pag.1/1

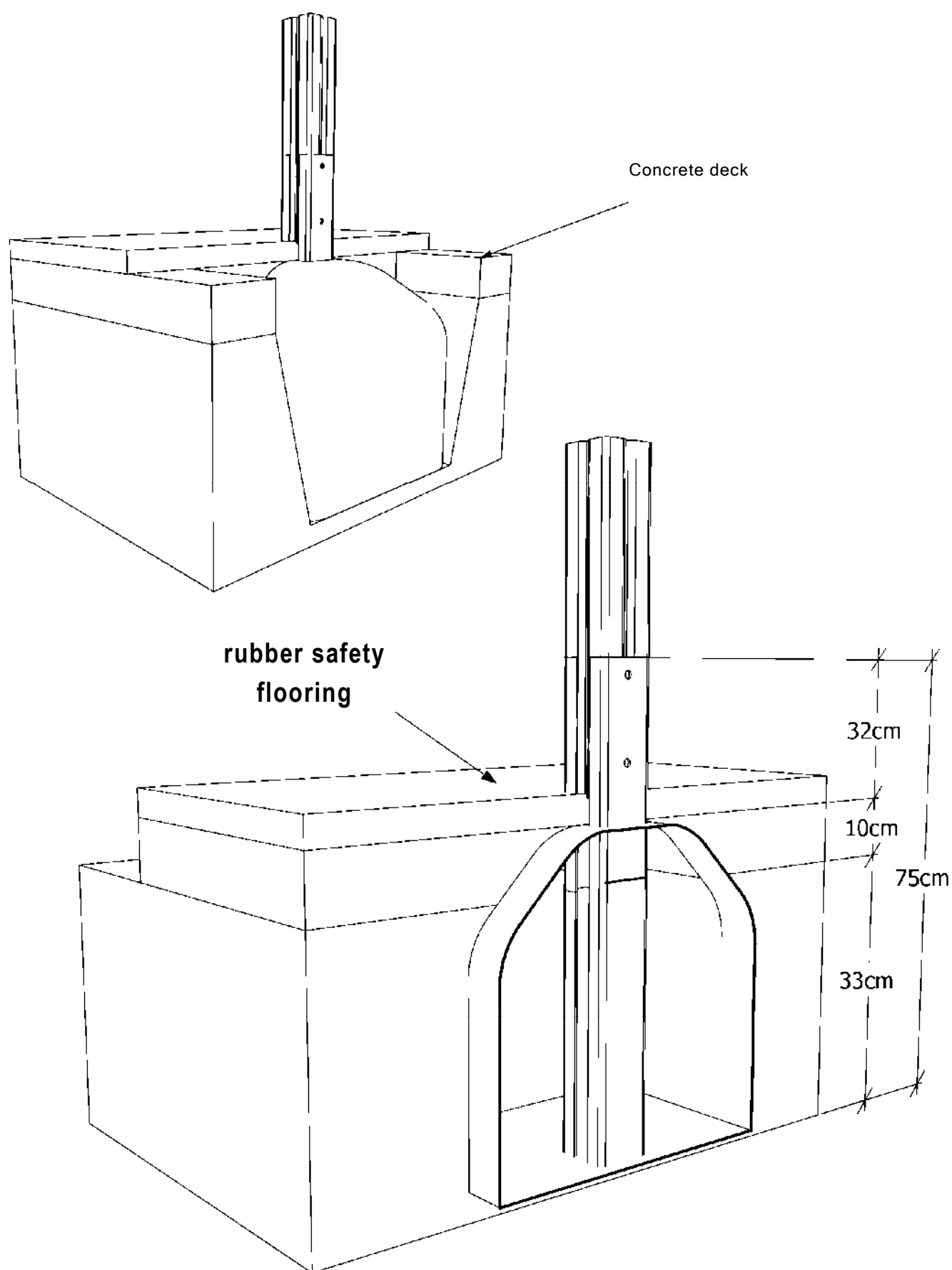

Le misure sono espresse in cm.	<b>SOLZBO</b>		
Colori e modelli rappresentati sono puramente indicativi	denominazione e/o cliente :	istruzioni montaggio interro montanti	
firma esecutore : 	data : 15.02.2011	nr.	pag. 1/1

1. Excavate a hole with diameter of 30 cm and depth of 60 cm

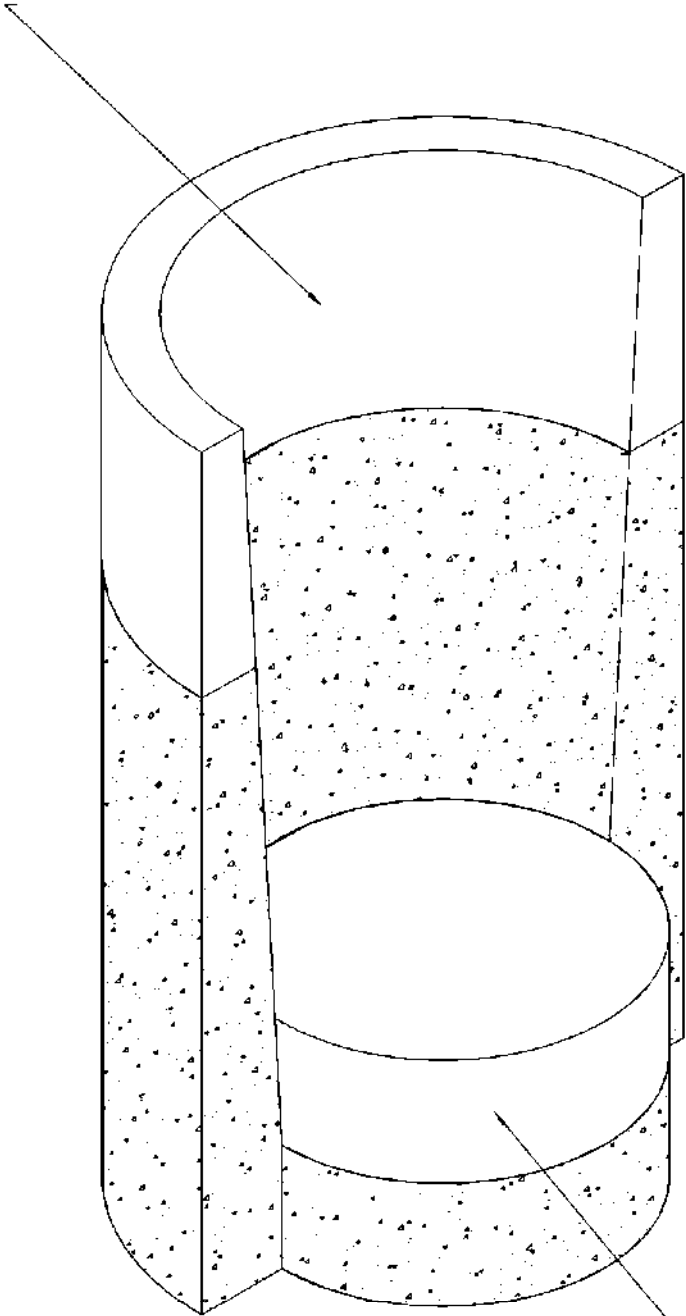

2. Cast a first layer of concrete with thickness of 10 cm.

Le misure del disegno sono espresse in    cm			
<div>Tolleranze generali applicate: *Sezione/diametro legno: impregnato <math>\pm 0,5</math> (cm) *Lunghezza legno: impregnato <math>\pm 0,1</math> (cm) *Lavorazioni legno: impregnato <math>\pm 0,2</math> (cm) *Componenti in metallo <math>\pm 1</math> (mm) *Componenti in altri materiali plastici <math>\pm 1,5</math> (mm)</div>		denominazione e/o cliente:	Istruzioni di montaggio interro scivolo curvo Pe
firma esecutore:	<i>Altieri</i>	data:	31.05.05    nr.    Pag. 1

3. When the concrete has set, position the slide bracket in the excavation hole, checking the correct alignment of the lower part of the slide with the finished ground level.

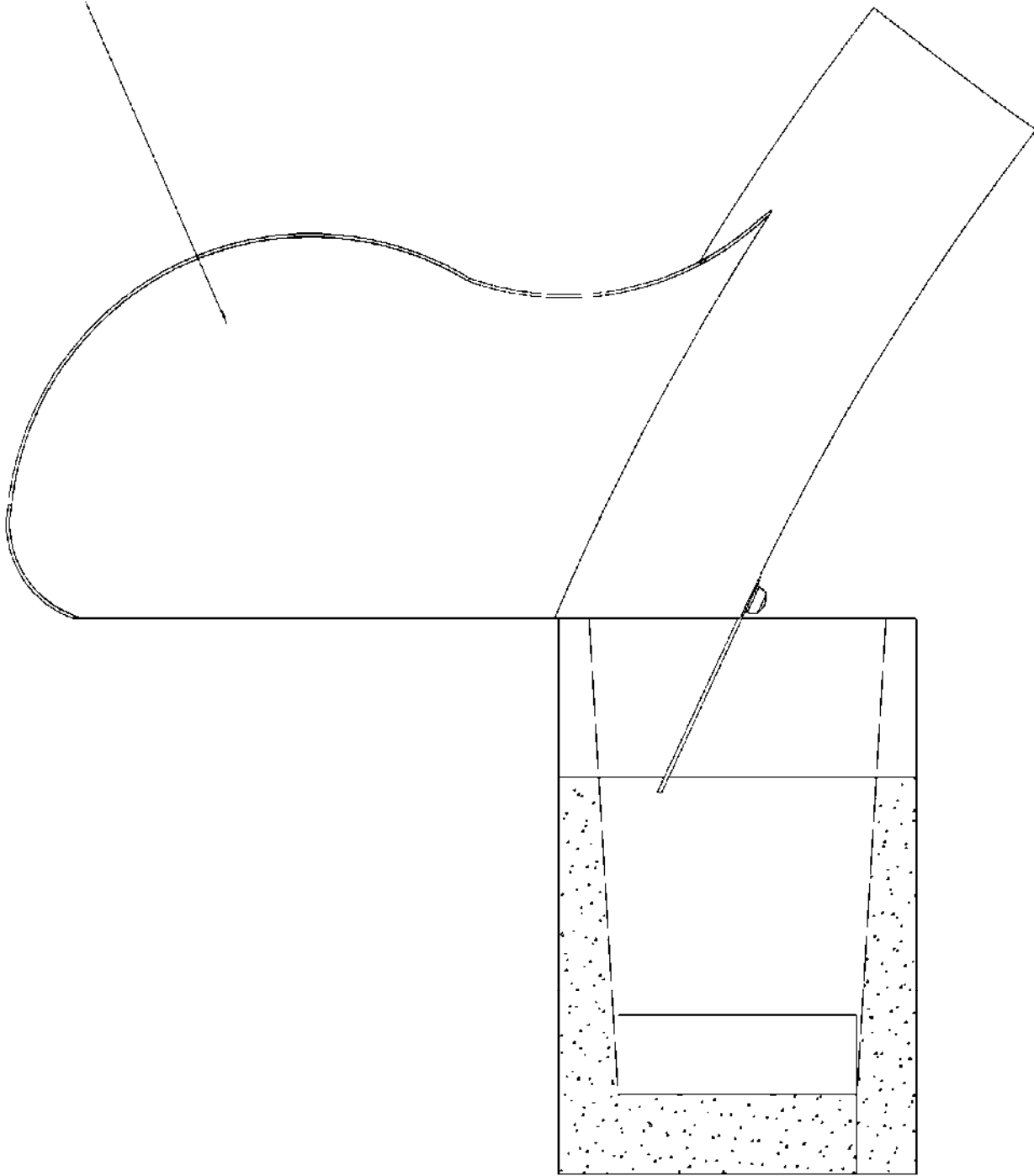

Le misure del disegno sono espresse in    cm		HOLZHOFF	
Tolleranze generali applicate: *Sezione/diametro legname impregnato ± 0,5 (cm) *Lunghezza legname impregnato 19a/lung. totale *Lavorazioni legname impregnato + 0,2 (cm) *Componenti in metallo ± 1 (mm) *Componenti in altri materiali plastici ± 1,5 (mm)		denominazione e/o cliente:	Istruzioni di montaggio interro scivolo curvo Pe
firma esecutore:	Altieri	data:	31.05.05    nr.    Pag. 2

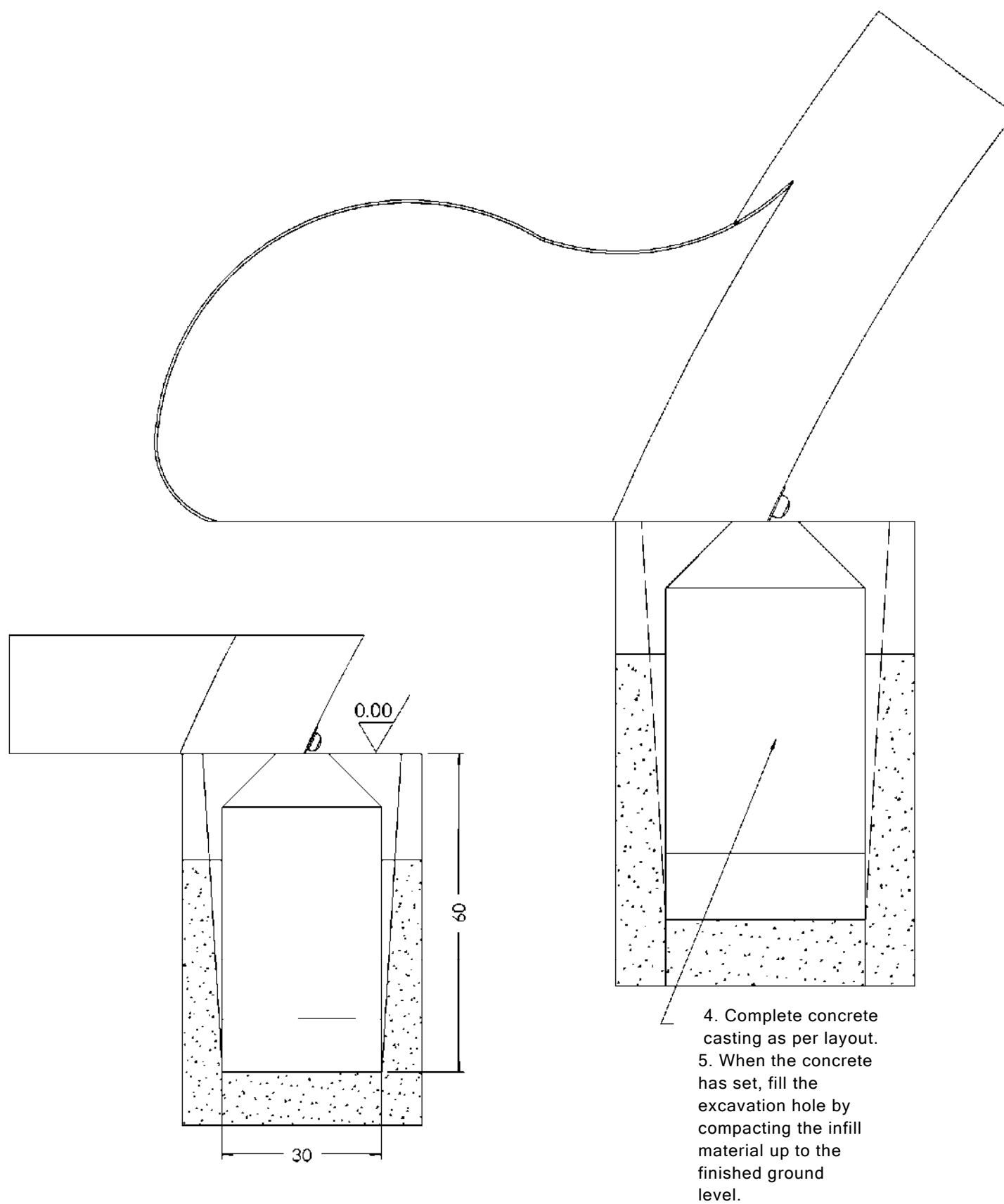

Le misure del disegno sono espresse in		HOLZHOFF	
Tolleranze generali applicate: *Sezione di diametro legno impregnato $\pm 0.5$ (cm) *Lunghezza legno impregnato $\pm 0.2$ (cm) *Lavorazioni legno impregnato $\pm 0.2$ (cm) *Componenti in metallo $\pm 1$ (mm) *Componenti in altri materiali plastici $\pm 1.5$ (mm)		denominazione e/o cliente:	Istruzioni di montaggio interro scivolo curvo Pe
firma esecutore:	Altieri	data:	31.05.05
		nr.	Pag. 3

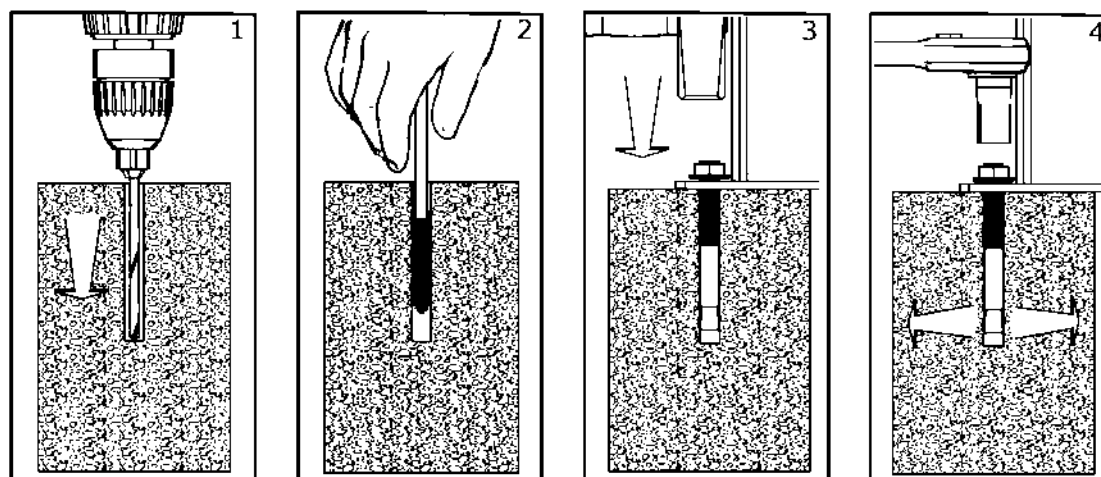

1. Drill.
2. Clean the hole thoroughly using an air pump and small brushes.
3. Insert the anchor into the hole present on the bracket with the aid of a hammer.
4. Tighten using dynamometric wrench.

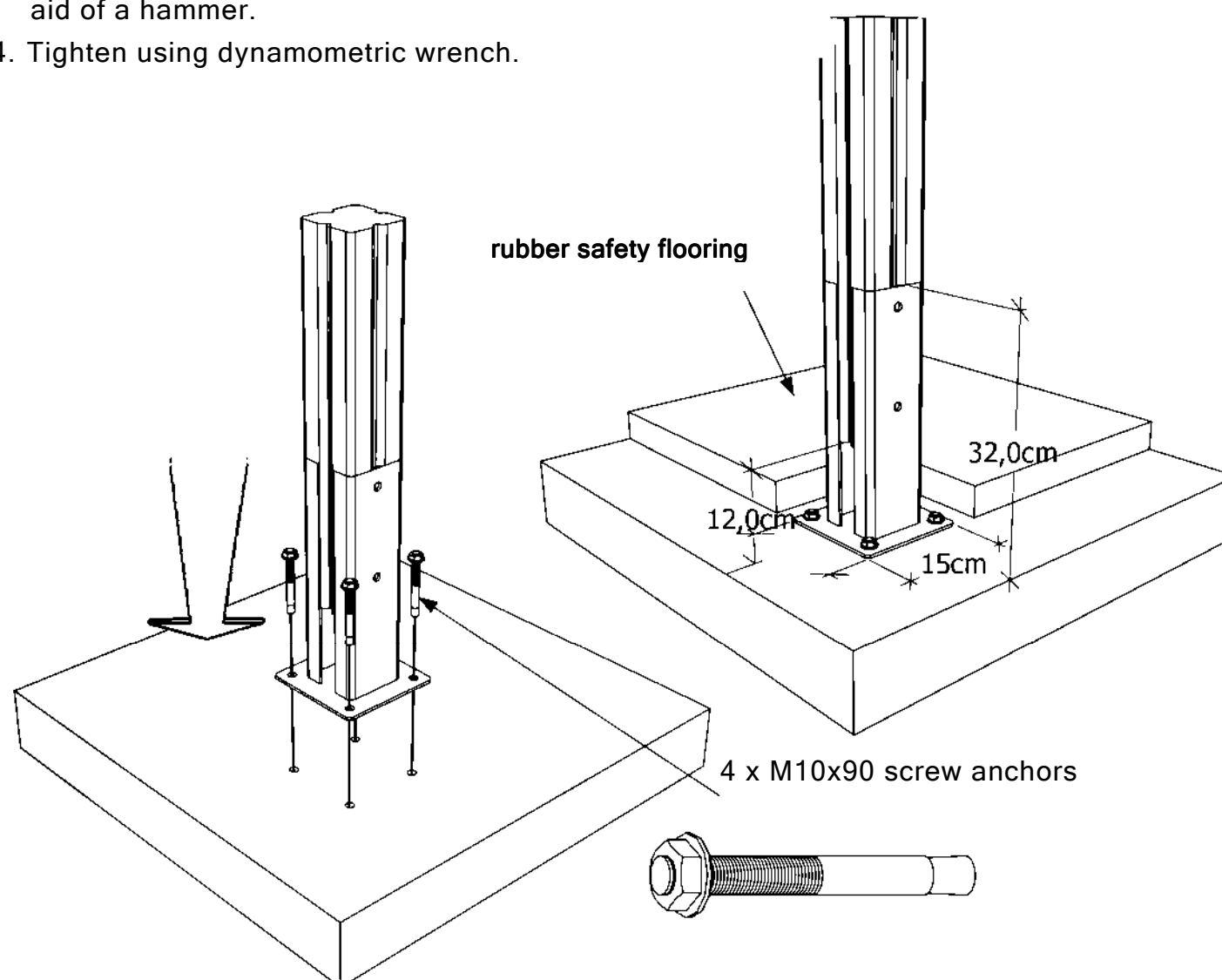

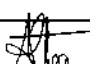
Le misure sono espresse in cm.	<b>SOLZROE</b>		
Colori e modelli rappresentati sono puramente indicativi	denominazione e/o cliente :	<b>istruzioni di montaggio ancoraggio montanti con staffe</b>	
firma esecutore : 	data : 14.02.2011	nr.	pag.1

Article num.	Quantity	CODE N.	NAME
1	1	xfe265	59x59x35 stainless steel angle
2	2	xpe10	PE nut protection cap
3	2	xpe116	PE cap
4	1	—	M10 self-locking nut
5	1	—	M8x115 screw anchor
6	1	—	Ø10 washer

1. Position the slide on the support surface, marking the position of the screw anchor.
2. Drill the support surface and position the screw anchor.
3. Fix the angle bracket to the support surface using the relevant bolts, as indicated in the figure.

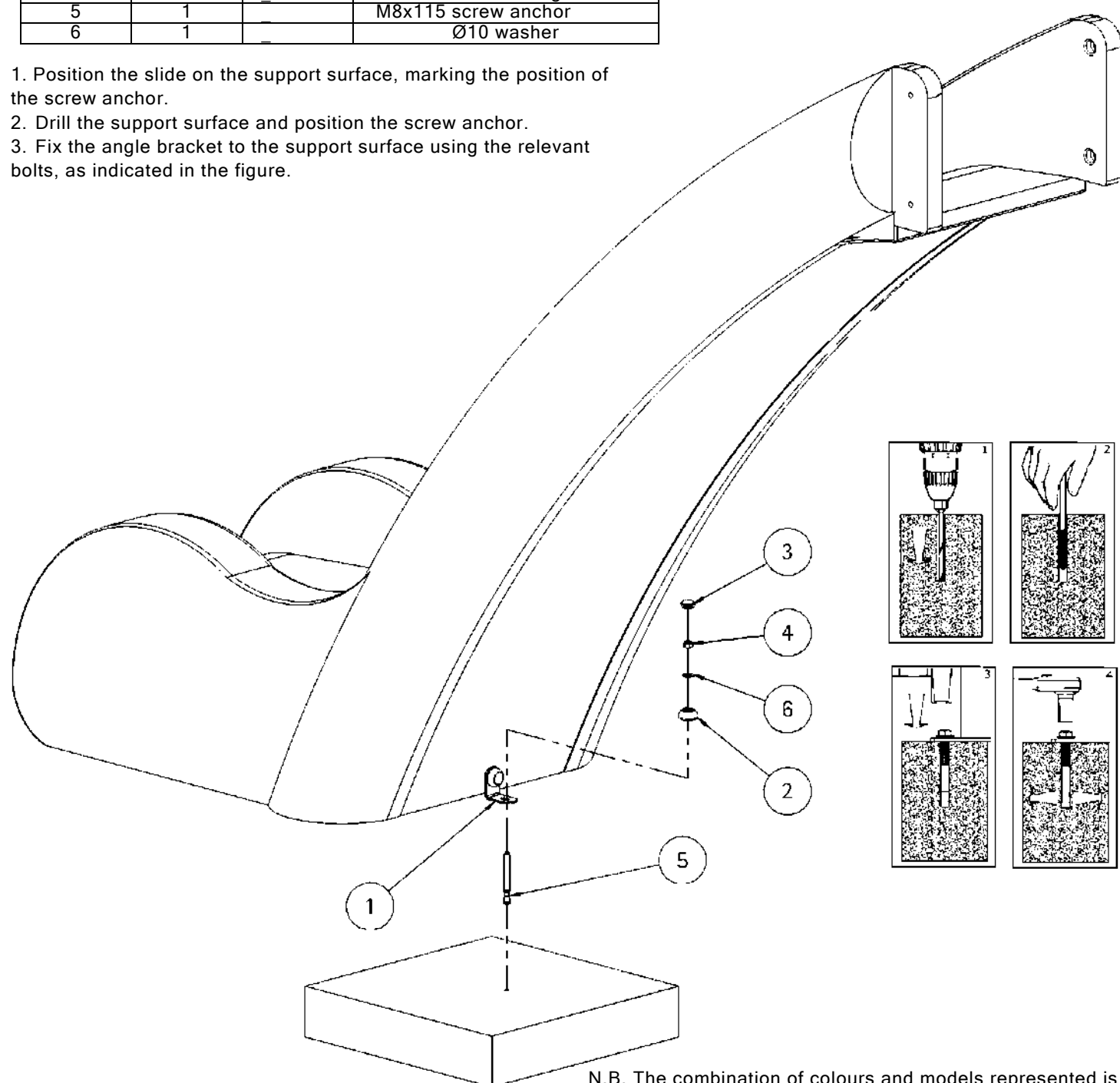

N.B. The combination of colours and models represented is purely indicative.  
The slide can be at a height of 84-144-192 cm.

Le misure del disegno sono espresse in	cm	
Tolleranze generali applicate: *Sezione/diametro legname: imprecisato $\pm 0.5$ (cm) *Lunghezza: legname: imprecisato $\pm 0.5$ (cm) *Lavorazioni legname: imprecisato $\pm 0.2$ (cm) *Componenti in metallo: $\pm 1$ (mm) *Componenti in altri materiali plastici: $\pm 1.5$ (mm)	denominazione e/o cliente:	istruzioni di montaggio ancoraggio scivolo curvo pe
firma esecutore:	<i>Altieri</i>	data: 16.02.2011 nr. pag.1